



**EAGLE TECHNICAL ADVISORY COMMITTEE
Community Development/Public Works Center
1500 Monroe Street, Ft. Myers, FL
Second Floor Conf. Rm. 2C**

**TUESDAY, JUNE 8, 2021
3:00 P.M.**

AGENDA

- 1) Call to Order
- 2) Paul Owen with *DexBender*, Present Bald Eagle Management Plan for 2521 Tamiami Trail Parcel Nest LE981
- 3) Approval of Minutes – March 9, 2021
- 4) Lost and abandoned nest determination
 - A. Abandonment determination for LE-045, Ida's Nest
 - B. Abandonment determination for LE-063, Luckett Rd
 - C. Abandonment determination for LE-057, Pinehurst Rd
 - D. Abandonment determination for LE-010E and LE-010C
 - E. Abandonment determination for LE-006K Singing Pines
 - F. Abandonment determination for LE-043B, Moody River Estates
 - G. Abandonment determination for LE-024C, Lisa's Nest (PI Flatwoods)
 - H. Abandonment determination for LE-016C, Lisa's Nest (PI Flatwoods)
 - I. Abandonment determination for LE-038C, Temple Judah
- 5) Member Reports
- 6) Public Input
- 7) Adjournment – Next Tentative Meeting Date: July 13, 2021

To view a copy of the agenda, go to www.leegov.com/dcd/calendar.
For more information, contact Debbie Carpenter (239) 533-8345 or dcarpenter@leegov.com. In accordance with the Americans with Disabilities Act, Lee County will not discriminate against qualified individuals with disabilities in its services, programs, or activities. To request an auxiliary aid or service for effective communication or a reasonable modification to participate, contact Joan LaGuardia, (239) 533-2314, ADArequests@leegov.com or Florida Relay Service 711. Accommodation will be provided at no cost to the requestor. Requests should be made at least five business days in advance.

**MINUTES REPORT
EAGLE TECHNICAL ADVISORY COMMITTEE
(ETAC)
Tuesday, March 9, 2021**

Committee Members Present:

Betsie Hiatt, Vice-Chair
Mike Myers
Ed Elms

Excused / Absent:

Laura Greeno, Chair

Lee County Government Staff Present:

Becky Sweigert, DCD Planning
Nic DeFilippo, DCD Planning
Michael Jacob, Deputy County Attorney
Debbie Carpenter, DCD Administration

Outside Consultants/Members of the Public Present:

Laura Herrero, Johnson Engineering
Kyle Philpot
Charles Thompson, Seagate
Matt Price, Seagate
Joe Madden, Madden Law Fire

CALL TO ORDER:

Ms. Betsie Hiatt called the meeting to order at 3:03 pm in the first floor conference room 1B of the Community Development/Public Works Center, 1500 Monroe Street, Ft. Myers, Florida. Introductions were made.

Ms. Hiatt started discussion with Item #3. Item #2, approval of the minutes would follow.

SEAGATE ALICO NORTH INDUSTRIAL PARK

Ms. Laura Herrero, Johnson Engineering introduced the Seagate Alico North Industrial Park Bald Eagle Management Plan (BEMP) stating that the developer was in the process of obtaining a development order and environmental approvals for a project in the area of Three Oaks Parkway, Oriole Road Extension and McGarvey Research Park, specifically for the Seagate Alico North Industrial Park, when a new bald eagle nest was identified during a South Florida Water Management District (SFWMD) site review on February 10, 2021. Johnson Engineering (JEI) was brought in to assist the developer with the preparation of a management plan, to coordinate with agencies, and for monitoring. A BEMP was prepared and sent for ETAC review in mid-February with a different site plan. A revised BEMP that modified the site plan in an effort to minimize impacts within the primary zone was emailed to the committee on 3/8/21 just prior to this meeting.

On February 18, 2021, JEI confirmed that the nest was active. On March 5, 2021, it was confirmed that the nest had two bald eagle chicks almost ready to fledge. Monitoring will continue until both chicks have been documented to have fledged.

Ms. Herrero said the nest is not on the Seagate property being developed but is north and west of Oriole Road on property owned by another entity, about 75' off the ground in a slash pine. The proposed plan includes development of two lots along the western side of the Seagate property, both outside the 660' buffer except for a small portion of the southwest lot, however a spine road is needed to provide access. The original development plans were revised to move the spine road as far north as possible away from the nest tree to help minimize impacts, but a portion remains inside the 660' zone. She pointed out the nest location, the 330' and the 660' radius protection zones on aerial. As a result of conversations with Florida Fish and Wildlife Service (FWS) the BEMP now includes a phased approach to development. Phase 1 would include construction of the spine road that is necessary for access to the western lots to be developed. Construction would begin following approval of the development order and other required permits during non-nesting season, and only after the birds have fledged. The intent is to have the road construction completed prior to the start of nesting season (October 2021), however, should construction not be finished before that time, the developer would provide monitoring according to the FWS Bald Eagle Monitoring Guidelines. While Phase 1 is in process, the owner will apply for an Incidental Take permit, as recommended by FWS, for the rest of the proposed development work within the 660' buffer (as documented by emails included for Committee review). Phase 2 will not commence until the Incidental Take Permit has been obtained.

Mr. Matt Price spoke on behalf of Seagate Development stating that every effort has been made to minimize impacts but that there are three entities affected by this eagle nest (and he has been contact with each) and the size of this development, 20 acres, does not allow for a complete redesign of the project.

Ms. Herrero said that at this time, the plan is to obtain an approval to move forward with the development plan as shown which minimizes impacts by pushing the road outside the 330' zone and with the commitment that there will be no construction in the 330' zoning during eagle nesting season.

Ms. Herrero said there is a forested preserve which is part of a SFWMD conservation easement on the property. Mr. Elms asked about the specific location of the preserve, and Ms. Herrero located it on aerial showing that it was just outside the 660' zone. Mr. Elms asked about the vegetation between the nest and the proposed roadway and Ms. Herrero said it is forested and very thick with a mix of pines and melaleuca. She said JEI staff had walked the area and where the road would be, the nest could not be seen. This visual barrier will remain during construction but Seagate would have no control over other entities. Mr. Elms was concerned about the amount of disruption and how it might affect the chicks and asked if it would be possible to wait to begin any work until after the birds had fledged and were independent of the adults – in other words, were not returning to the nest for food. Ms. Herrero said that JEI will be monitoring the birds and their progress, but since there was some delay in obtaining the development order as a result of finding this nest, there is still some time before it is issued and this should not be an issue.

Ms. Sweigert referred to the site plan and the reference to a building height of 55'. Mr. Thompson said the maximum building height on the north side can only be 24', on the south only 30', per code. She asked about the building's footprint. He was not able to talk about specifics since he did not know what will be going there. Ms. Sweigert asked if they had looked at the incentives for the 330' protection zones, but again he said because there are multiple ownership groups these things will be contingent on what happens after the spine road is in.

Ms. Sweigert said it appeared that the focus for now is Phase 1 and Ms. Herrero confirmed that the spine road was needed to access the western lots, and that Phase 2 would not commence until after receipt of the Incidental Take Permit. Ms. Sweigert confirmed her understanding which was that the Committee would be approving Phase 1 of the BEMP at this time in order to construct the spine road, but would return to ETAC for review and discussion of Phase 2.

Mr. Michael Myers made a motion to recommend approval of Phase 1 as outlined in the BEMP, with the condition that the BEMP will be brought back for a review of Phase 2 after obtaining the Incidental Take Permit from FWS. Mr. Elms seconded. The motion was called and passed unanimously.

Mr. Sweigert said she would coordinate with the applicant on Board approval, anticipating that the Board would review the BEMP at one of the April meetings.

APPROVAL OF MINUTES – JANUARY 12, 2021

Ms. Hiatt called for a review of the January minutes. There were no comments or changes.

Mr. Myers made a motion to approve the January minutes as written. Mr. Elms seconded. The motion was called and was approved unanimously.

Member Comments/Discussion

Ms. Sweigert thanked the committee for looking at the Seagate BEMP, especially since the changes were made last minute. She had been skeptical about whether this was going to be a real bald eagles nest because it was not far from one to the south which was active and had 2 chicks, and then there was another close by as well. She thought that this might be the Daniels Marketplace pair because of the way the nest has been constructed - sides are hidden, top part is flat – like #58. If it is that pair then they are definitely acclimated to a lot of noise. Mr. Myers asked if the nest could have been there last year, but she thought not, since Mr. DeFilippo had been there in September and he had not seen it then.

Member Reports

Mr. Elms:

- Galt Preserve - 1 chick was perched on the side of the nest, perhaps 9-10 weeks old. Adults were not there.
- Vacation Lane/Cactus Point – Neither adult was there, but he saw 1 chick, probably 7 or 8 weeks old, high in the nest.
- St. Jude – 1 adult was there with 1 chick. He had seen 2 chicks in the past, but this time could only see one. Chick was probably 8 to 9 weeks old.
- St. James/Post Office – No activity that he could see. They are either really hidden, or went somewhere else. Ms. Sweigert was going to follow up with her contact out there.
- Pine Island Flatwoods – He said that Mr. DeFilippo had given him a map of the area. Two of the nests were far back by the mangroves, too far on foot. One was about half a mile, walking distance, from the parking lot but it had rained recently when he was there and he wasn't able to get back there. Ms. Sweigert was going to check with her 20/20 contacts to check on it.

Mr. Myers:

- St. Charles Harbor - He saw 1 adult and 2 chicks. Second adult did fly in just before he left.

- Robalo – He saw one head pop up out of the nest. Brief discussion that permission's been given to go on to the property, but there is a gate. Ms. Sweigert suggested parking off to the side and then walking around the gate.
- Jonathan Harbor – He saw one head pop up in the nest and saw both adults. Ms. Sweigert relayed that a resident had called her a couple weeks ago that an adult bird had died and that one of her neighbors had seen a fight between two birds; but then texted to say she had seen 2 adults near her house. Mr. Myers had seen two adults circling the nest tree so maybe a new adult has come in to help raise the young.
- Sanibel Sunset – nothing new there. He did see young owls at the osprey platform again where there were owls last year.
- Alico Road – He saw both adults and 2 chicks in the nest.
- Lakes Park – He saw 2 adults perched on the cell tower.
- Pub & Pickle – 2 young in the nest. Did not see the adults. (Ms. Sweigert said this was the second most watched nest after the Pritchett nest)
- Lexington Middle – He saw 1 adult, 1 young.
- Sora Drive – He saw 1 adult and 2 young.
- Tortuga – he saw both adults perched in dead Australian Pine snag and watched 1 young fly out of the nest.
- Oriole Road – He drove by and saw 1 young.

Ms. Hiatt:

- Bank of America – nothing going on there. She saw 1 adult early in the nesting season but nothing since. The nest is still in good condition. The property across the street is well under construction and has their eagle barrier there, but she suggested it might be time to release that restriction.
- Barrancas – She has consistently seen the adults and thought she had seen incubating behavior but didn't see any chicks (but it was a cold and windy day).
- Quail Trail – 1 chick about 6 weeks old, 1 adult in the nest.
- Pacosin – Still not seeing anything there and has had no reports of any activity.
- Esther – 1 chick in the nest.
- Helen Road – There has been no activity; she has given up on this one for the season.
- Cubes – Same. No activity.

Mr. Myers asked about Tranquility Bay. Ms. Sweigert said there is no access to that area anymore. The forage is there, the trees are there but there's no access. No development ever took place out there.

Mr. Elms asked about the North Fort Myers nests. Ms. Sweigert said the Moody tree is dead. Mr. DeFilippo saw 2 chicks in the cell tower nest. There was 1 chick at Bayshore Commons.

Ms. Sweigert reported that there was a new nest reported on Captiva, a residential lot just as you come onto Captiva. There were 2 chicks, but both died within a few days of each other. There was also a chick at South Seas that went to CROW but that one passed also.

Ms. Sweigert said the next meeting was tentatively scheduled for April 13, 2021 but if there were no requests or public it may be postponed.

There was no public present and no further discussion. Ms. Hiatt adjourned the meeting at 4:07 p.m.

2521 Tamiami Trail Parcel Bald Eagle Management Plan Nest LE981

Section 27, Township 43 South, Range 24 East
Lee County, Florida

March 2021

Prepared for:

**Mayfair Hall, LLC
980 N Michigan Avenue, 12th Floor
Chicago, IL 60611**

Prepared by:

***DexBender*
4470 Camino Real Way, Suite 101
Fort Myers, FL 33966
(239) 334-3680**

I. INTRODUCTION

The 23.3± acre project is located at 2521 Tamiami Trail in Lee County, Florida (Figure 1). The lands to the north, south, and west of the site consist of developed land. North Tamiami Trail is located to the east. South of the property, nest LE981 is on a communications tower within the 660' of the subject property.

The nest was inactive during the 2020-2021 nesting season and it is undetermined when the nest was last active. The eagles have constructed a nest (LE981) in a communications tower located approximately 350 feet south of the south property line and 700 west of Winkler Road.

A bald eagle management plan will need to be approved for the LE981 nest by Lee County as a portion of the proposed outdoor storage facility will be within the 660' eagle buffer zone.

This management plan has been created to outline the project's proposed protection measures for Nest LE-040B.

II. SITE CONDITIONS

The 2521 Tamiami Trail property consists of open and developed land, which has been used as an outdoor drive-in theater in the past. This disturbed upland area is vegetated primarily by slash pine (*Pinus elliotti*), live oak (*Quercus virginiana*) and laurel oak (*Quercus laurifolia*) with scattered carrotwood (*Cupaniopsis anacardioides*) and melaleuca (*Melaleuca quinquenervia*) in the canopy, with Brazilian pepper (*Schinus terebinthifolius*) in the shrub stratum. The property on which Nest LE981 is located (16021 Oneal Drive, North Fort Myers) consists of developed land. There is a building and outdoor storage actively being used on the properties between the nest and the subject property.

III. SITE OBSERVATIONS

No previous nest history is known. Four vegetation associations were identified using the Florida Land Use, Cover and Forms Classification System (FLUCCS). Figure 2 depicts the approximate location and configuration of these vegetation associations and Table 1 summarizes the acreages by FLUCCS Code. A brief description of each FLUCCS Code is also provided below.

SECTION: 27
TOWNSHIP: 43 S
RANGE: 24 E

2521 Tamiami Trail

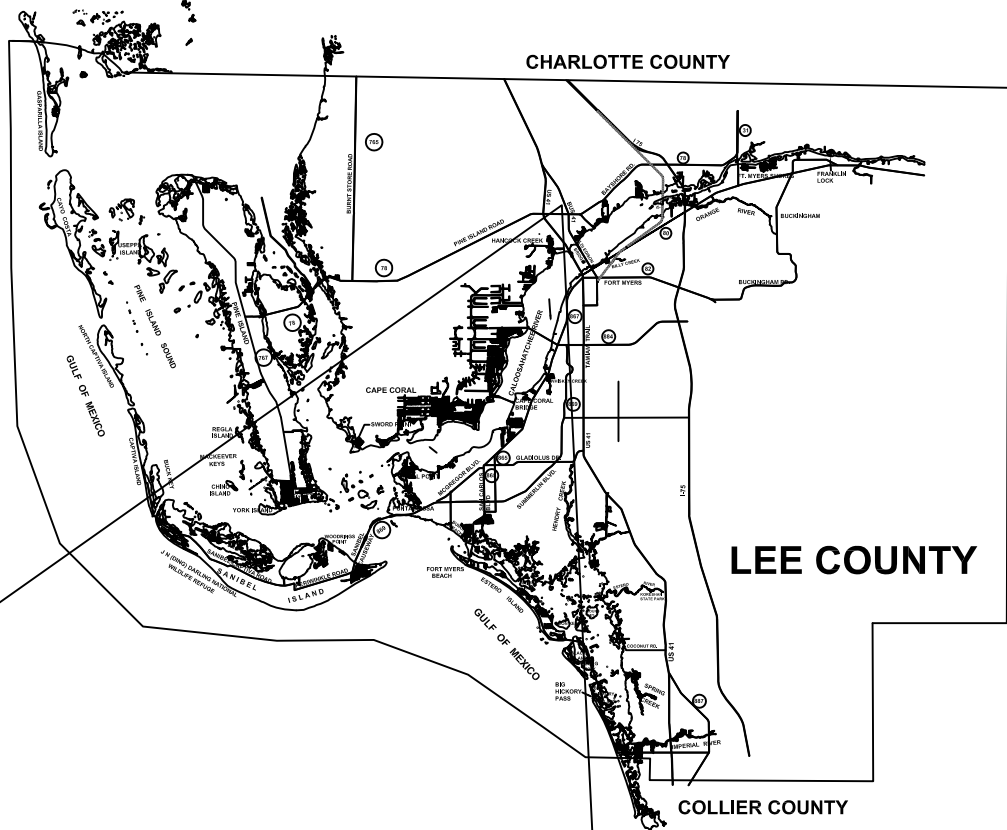

Project Location

*PERMIT USE ONLY,
NOT FOR CONSTRUCTION*

November 15, 2019 1:37:18 p.m.
Drawing: MAYFAIR2LOCATION.DWG

Location Map

DEXBENDER
ENVIRONMENTAL CONSULTING
FORT MYERS 239-334-3680

SECTION: 27
TOWNSHIP: 43 S
RANGE: 24 E

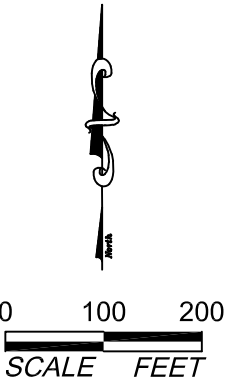

FLUCCS	Description	Acreage
144	Cultural and Entertainment	12.63 ac.
190	Open Land	2.23 ac.
414DE3	Disturbed Pine - Mesic Oak Invaded by Exotics (51-75%)	7.82 ac.
742	Borrow Areas	0.61 ac.
Total		23.29 ac.

- Notes:
1. Property boundary is approximate and was obtained from the Lee County Property Appraiser's Website.
 2. Mapping based on photointerpretation of 2020 aerial photography and ground truthing in November 2019.
 3. Location of Bald Eagle Nest LE-981 is approximate.

PERMIT USE ONLY, NOT FOR CONSTRUCTION

March 22, 2021 4:20:18 p.m.
Drawing: MAYFAIR2PLAN.DWG

Bald Eagle Nest Location

2521 Tamiami Trail

Table 1. Acreage Summary by FLUCCS Code

FLUCCS CODE	DESCRIPTION	ACREAGE
144	Cultural and Entertainment	12.63
190	Open Land	2.23
414DE3	Pine-Mesic Oak, Disturbed, Invaded by Exotics (51-75%)	7.82
*742	Borrow Areas	0.61
Upland Subtotal		22.68
Wetland Subtotal		0
Other Surface Water Subtotal		0.61
Total		23.29

FLUCCS Code 144, Cultural and Entertainment

This upland area is an abandoned drive-in movie theater which is currently used as a flea market. Bahia grass (*Paspalum notatum*), smutgrass (*Sporobolus indicus*) and widely scattered slash pines are found in the unpaved areas.

FLUCCS Code 190, Open Land

This open upland field is associated with the drive-in theater and includes bahia grass, smutgrass, broomsedge (*Andropogon virginicus*), ragweed (*Ambrosia artemisiifolia*), and Florida pusley (*Richardia scabra*).

FLUCCS Code 414DE3, Pine-Mesic Oak, Disturbed, Invaded by Exotics (51-75%)

This disturbed upland area is vegetated primarily by slash pine, live oak and laurel oak with scattered carrotwood and melaleuca in the canopy, Brazilian pepper in the shrub stratum, and grape vine (*Vitis sp.*), cogongrass (*Imperata cylindrica*), smutgrass, bahia grass, Caesar weed (*Urena lobata*), sandspur (*Cenchrus sp.*), beggar tick (*Bidens sp.*), guineagrass (*Panicum maximum*), pepper-vine (*Ampelopsis arborea*), greenbrier (*Smilax sp.*), and Virginia creeper (*Parthenocissus quinquefolia*) in the herbaceous stratum.

FLUCCS Code 742, Borrow Areas

These two borrow areas are located in the southwest portion of the site and include willow (*Salix caroliniana*), Brazilian pepper, and spatterdock (*Nuphar luteum*).

IV. GENERAL DEVELOPMENT GUIDELINES

The protection measures outlined below have been designed utilizing the FWS's *National Bald Eagle Management Guidelines* (FWS 2007a) and Section 14-111 through 14-120 of the Lee County Land Development Code. These proposed restrictions and requirements apply only to the 2521 Tamiami Trail project and are not binding on any other property in the vicinity of Bald Eagle Nest LE981.

If Nest LE981 is vacated before the end of the nesting season (May 15th) or if Lee County Division of Environmental Sciences (DES) determines that Nest LE981 has been abandoned, construction activities may commence upon confirmation of those conditions by DES. If the nest is not active by March 15th or as confirmed by DES, then the nesting season for Nest LE981 shall be considered over and the construction restrictions shall not apply. A determination that the nest is not active shall be consistent with the *Bald Eagle Monitoring Guidelines* (FWS 2007b).

A. 330 Feet Zone Activities and Restrictions

The project parcel area is not located within the 330' LE981 nesting buffer. The proposed drainage ditch that will run parallel to Pinto Road, shall only be constructed during non-nesting season (i.e., May 16th - September 30th) (Figure 3).

B. 330 - 660 Feet Zone Activities and Restrictions

Approximately 4.2 acres of the property are within the 660' buffer of Nest LE981 (Figure 3). The project will include drive isles and improved/filled storage lots for outdoor storage with an emergency access via Pinto Road within the 660' zone. The restrictions described below are only applicable to the portion of the property within 660' of Nest LE981.

1. Major exterior construction activities, such as initial site clearing, major earth work, grading, drive isles construction, and access road construction may occur during the nesting season provided that the activities do not disturb the nesting bald eagles as defined by the *Bald Eagle Monitoring Guidelines*. Monitoring consistent with the *Bald Eagle Monitoring Guidelines* shall be required during these construction activities.
2. The use of any chemicals that are known to be toxic to wildlife shall be prohibited within 660± feet of the bald eagle nest. The use of all chemical will be in accordance with labeling instructions.
3. Outdoor lighting installed within 660± feet of the bald eagle nest shall be subdued, shielded, and directed away from the nest tree.
4. After construction is completed, normal storage facility activities will be allowed throughout the year.

2521 Tamiami Trail

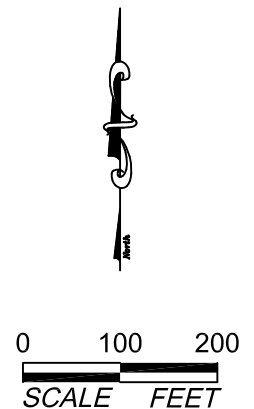
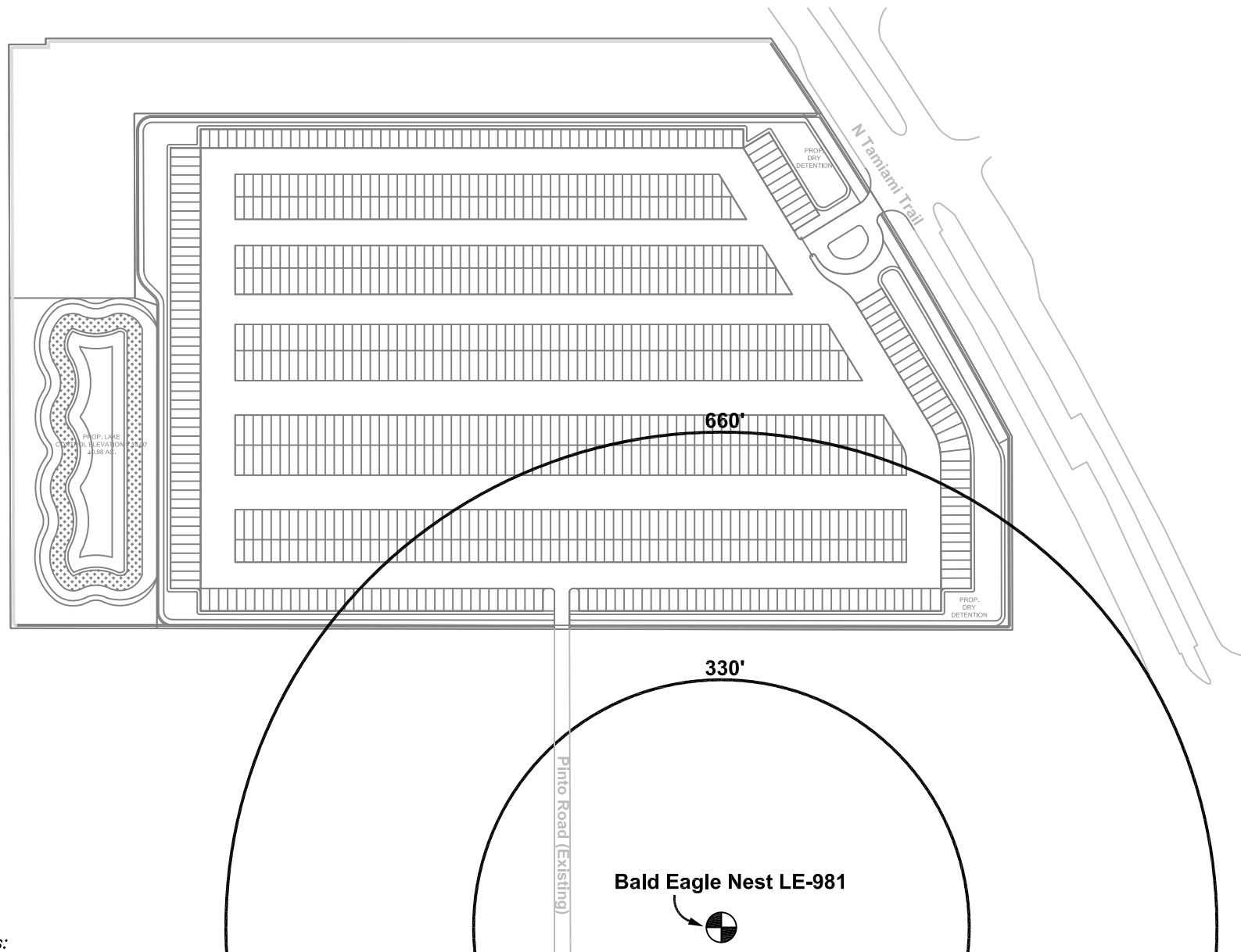

SECTION: 27
TOWNSHIP: 43 S
RANGE: 24 E

- Notes:**
1. Property boundary is approximate and was obtained from the Lee County Property Appraiser's Website.
 2. Location of Bald Eagle Nest LE-981 is approximate.

PERMIT USE ONLY, NOT FOR CONSTRUCTION

March 31, 2021 1:17:13 p.m.
 Drawing: MAYFAIR2PLAN.DWG

Site Plan

DEXBENDER
 ENVIRONMENTAL CONSULTING
 FORT MYERS 239-334-3680

C. Greater Than 660 Feet Zone Activities and Restrictions

The proposed uses of the property more than 660 feet of Bald Eagle Nest LE981 consist of the remainder of the residential development. Construction activities and normal residential activities will be allowed outside of 660± feet of the bald eagle nest throughout the year.

V. IMPLEMENTATION

The land owner/developer and the future Property Owners Association (if any) will be responsible for following this Bald Eagle Management Plan. A qualified ecologist will monitor Nest LE981 (if work as described by Item IV.B.1 above is undertaken during the nesting season) consistent with the *Bald Eagle Monitoring Guidelines* and will submit the reports to DES on a monthly basis. DES staff will review these reports and may also inspect the site to verify compliance with the conditions of this Bald Eagle Management Plan. Any violation of these conditions may result in a Stop Work Order being issued to halt all construction activity during the bald eagle nesting season, including building inspections, until the violation is resolved.

All of the management practices will remain in effect until the nest is deemed abandoned or lost by DES pursuant to Section 14-112 of the Land Development Code. None of these management practices will be required after the nest is deemed abandoned or lost. The nest will be defined as abandoned if the nest is intact or partially intact but has been inactive through five or more consecutive nesting seasons. The nest will be defined as lost if the nest or nest tree is destroyed by natural causes (e.g. nest that fell apart or was blown out of a tree, or the tree itself was lost) and is not rebuilt in the same tree within three nesting seasons.

VI. BALD EAGLE MANAGEMENT PLAN MODIFICATIONS

Any changes to this Bald Eagle Management Plan must be reviewed and approved by DES staff through the planned development administrative amendment process. Any future owners of the 2521 Tamiami Trail project that are affected by this Bald Eagle Management Plan will be provided with a copy of this plan. At the time of platting, the Bald Eagle Management Plan will be included in the property association documents.

REFERENCES

Florida Fish and Wildlife Conservation Commission. 2008. Bald Eagle Management Plan. 60p.

Florida Fish and Wildlife Conservation Commission. 2017. Historical Bald Eagle Nesting Areas.

U.S. Fish and Wildlife Service. 2007a. National Bald Eagle Management Guidelines. 23p.

U.S. Fish and Wildlife Service. 2007b. Bald Eagle Monitoring Guidelines. 20p.

LE-45: Ida's Nesting History**Strap Number: 22-43-24-00-00003.0010**

Year	History
92-93	Active, 2 Fledglings confirmed
93-94	Active, 2 Fledglings confirmed
94-95	Active, 2 Fledglings confirmed
95-96	Active, 1 Fledgling confirmed
96-97	Active, 3 Fledglings confirmed
97-98	Inactive, No signs of birds; cypress nest shallow
98-99	Nest Down
99-00	Incubating posture observed 1/28/00.*
00-01	Active, 1 Fledgling confirmed
01-02	Active, 1 Fledgling confirmed
02-03	Active, 1 Fledgling confirmed
03-04	Adults observed in near nest showing signs of courtship at beginning of nesting season. Great Horned Owls occupied nest. Adults build nest across street in slash pine (west side of US 41)
04-05	Active, Failed
05-06	Active, 1 Fledgling confirmed
06-07	Active, 1 Fledgling confirmed
07-08	Active
08-09	Active
09-10	Active, 1 Fledgling confirmed
10-11	Active, 1 Fledgling confirmed
11-12	Inactive, Great Horned Owls occupied nest
12-13	Inactive

13-14	Inactive
14-15	Inactive
15-16	Inactive, no nest
16-17	Inactive
17-18	Inactive, Gone
18-19	Inactive
19-20	Inactive
20-21	Inactive

* Probably around 98-99 or 99-00 nesting season when nest relocated outside of cypress preserve to slash pine East of US 41.

LE-063: Grandma's Kitchen/I75&Luckett Rd Nesting History**Strap Number: 15-44-25-P2-U20295.4843**

Year	History
01-02	Active, 1 Fledgling confirmed, New nest observed in SE corner of I75 & Luckett Rd.
02-03	Active, 1 Fledgling confirmed
03-04	Active, 1 Fledgling confirmed
04-05	Active, 1 Fledgling confirmed
05-06	Failed
06-07	Active
07-08	Active, 2 Fledglings confirmed
08-09	Active, no Fledglings confirmed
09-10	Active, no Fledglings confirmed
10-11	Active, 1 Fledgling
11-12	Inactive, clearing up to 660ft
12-13	Active, 2 Fledglings confirmed
13-14	Active, 1 Fledgling not confirmed
14-15	Active, 1 Fledgling confirmed
15-16	Inactive,
16-17	Inactive, no nest activity. Nest is small
17-18	Inactive, no nest activity
18-19	Inactive
19-20	Inactive

FWC: Active in 15-16

LE-57: Pinehurst/Soaring Eagle Snag Nesting History**Strap Number: 29-44-22-00-00003.0030**

Year	History
04/05	Active, 1 Fledgling confirmed
05/06	Active, 1 Fledgling confirmed
06/07	Active, 2 Fledglings confirmed
07/08	Active, 1 chick Fledgling not confirmed
08/09	Active, 2 Fledglings confirmed
09/10	Active, 2 Fledglings confirmed
10-11	Active, 2 Fledglings confirmed
11-12	Active, 1 Fledgling confirmed
12-13	Active, 1 Fledgling confirmed
13-14	Inactive
14-15	Active, 2 Fledglings confirmed. New nest east of old new adjacent to palm grove
15-16	Inactive, unable to locate a nest
16-17	Inactive, unable to locate a nest
17-18	Inactive, unable to locate a nest
18-19	Inactive, unable to locate a nest
19-20	Inactive, unable to locate a nest
20-21	Inactive, unable to locate a nest

FWC last surveyed in 15-16 and couldn't find nest.

LE-10: Soaring Eagle Nursery/Cobb Rd. /Howard Rd. Nesting History

Year	History
95-96	Nest Failed
96-97	Inactive
97-98	Active, 1 Fledgling confirmed
98-99	Active, 2 Fledglings confirmed
99-00	Active, Failed
00-01	Inactive, Nest in poor condition
01-02	Active, 1 Fledgling confirmed
02-03	Active, Failed
03-04	Active, 2 Fledglings confirmed
04-05	Active, 1 Fledgling confirmed
05-06	Howard Road (LE-010C)snag Active, 2 Fledglings confirmed
06-07	Howard Road snag Active, 1 Fledgling confirmed
07-08	Howard Road snag, Active, 2 Fledglings confirmed
08-09	Howard Road snag, Active
09-10	Howard Road snag, Inactive/ Moved to Cobb Road
10-11	Cobb Road (LE-010E), Inactive
11-12	Cobb Road, Inactive
12-13	Not is season summary
13-14	Moved to Quail Trail, Active 1 Fledgling confirmed
14-15	Quail Trail, Active, Observed Incubating, but fledglings not confirmed
15-16	Quail Trail, Active, Observed Incubating, but fledglings not confirmed

16-17	Quail Trail, Inactive unable to locate
17-18	Quail Trail, Inactive
18-19	Quail Trail, Active 2 Fledgling
19-20	Quail Trail, Active 1 Fledgling
20-21	Unknown, Data not received yet

LE-006K: Riverbend/Singing Pines Nesting History**Strap Number: 31-43-25-00-00022.0000**

Year	History
89-90 LE-06E	Active, Fledgling(s) confirmed
90-91 LE-06E	Active, 1 Fledgling confirmed
91-92 LE-06F	Active, New nest, but bushhogging under nest tree
92-93 LE-06 E&F	Active, LE-06E gone and LE-06F active but no fledglings
93-94 LE-06G	Active, New nest, 3 Fledglings confirmed (LE-06F taken over by GHOW)
94-95 LE-06G	Active, 1 Fledgling confirmed
95-96 LE-06G	Active, 2 Fledglings confirmed
96-97 LE-06H	Active, New nest at tee off in Golf Course, 1 Fledgling
97-98 LE-06I	Active, New nest, 2 Fledglings confirmed. Nest down and tree dying at end of season
98-99 LE-06J	Active, New nest, 1 chick fell from nest, chick was tagged and returned to nest
99-00	No data. Eagles reported in area but uncertain of nesting success
00-01 LE-06K	Active, New nest, 2 chicks observed in nest, presumed fledged.
01-02	Active, 2 Fledglings confirmed
02-03	Active, 3 Fledglings confirmed
03-04	Active, 1 Fledgling confirmed
04-05	Active, Failed
05-06	Active
06-07	Active
07-08	Active
08-09	Active
09-10	Active, 1 Fledgling confirmed

10-11	Active, 2 Fledglings
11-12	Active, 1 Fledgling
12-13	Active, Seen incubating but fledglings not confirmed
13-14	Active, possible chicks not confirmed
14-15	Fail, chick died according to landowner
15-16	Fail, late incubation (February), feeding behavior in March, no chicks observed
16-17	Inactive, nest tree is dead and nest is small with vegetation growing over it. Moved to Bayshore Commons
17-18	Inactive, Nest tree gone
18-19	Inactive, No activity
19-20	Inactive, No activity
20-21	Inactive, No activity

FWC last known active – 2009

Last survey 2017- Activity Unknown

LE-43B: Moody River Estates Nesting History**STRAP #: 10-44-24-46-0000C.0000**

Year	History
03-04	New nest, 2 Fledglings confirmed
04-05	Active, 2 Fledglings confirmed
05-06	Active, no confirmed Fledglings
06-07	Active, no confirmed Fledglings
07-08	Incubation at nest but no Fledglings confirmed
08-09	Inactive, Nest falling apart
09-10	Active 2 Fledglings confirmed
10-11	Active 2 Fledglings confirmed
11-12	Active 2 Fledglings confirmed
12-13	Active 1 Fledgling confirmed
13-14	Active 2 Fledglings confirmed
14-15	Active Fail, Alternate nest to the north of nest tree built. Signs of incubation in alternate nest. GHO took over nest.
15-16	Inactive, adults observed in area but no nesting behavior observed
16-17	Inactive, alternate nest located near lot 40 in Moody River Estates was cut down 6/16/17. Original nest is gone but tree is in good shape
17-18	Inactive
18-19	Inactive, no remnants of nest
19-20	Inactive
20-21	Inactive

LE-24C: Janie's Nesting History**Strap Number: 15-45-22-00-00001.5000**

Year	History
01-02	Active
02-03	Active
03-04	No Data
04-05	No Data
05-06	No Data
06-07	No Data
07-08	No Data
08-09	Active
09-10	Active
10-11	Unknown, Nest Moved West
12-21	No nesting activity observed

No data has been reported for this territory since 2009-2010 nesting season.

LE-16C: Lisa's Nesting History**Strap Number: 15-45-22-00-00001.5000**

Year	History
01-02	Active
02-03	Active, 2 Fledglings confirmed
03-04	Active, 2 Fledglings confirmed
04-05	Active
06-21	No nesting activity observed

No data has been reported for this territory since 2004-2005 nesting season.

Lee County purchased the property in March 2005; however, no bald eagles have been observed at the territory since 2004-2005 nesting season. FWC website indicated last known activity as 2004-2005 season.

LE-38C Nest History (Temple Judea)**Strap Number: 29-45-24-00-00007.103B**

Year	History
12-13	Failed, one chick found at base of nest
13-14	Failed, major branch has broken off nest tree
14-15	Active, 1 Fledgling confirmed; nest in disrepair
15-16	Active, 1 Fledgling confirmed; nest tree dead
16-17	Active, 2 Fledglings confirmed; nest tree dead
17-18	Inactive, Australian pine is present but dead, upper branches gone. A very small portion of last year's nest still remained, damaged by Irma. No adult Bald eagle activity was observed at the nest or in the vicinity.
18-19	Inactive, Australian pine is dead. Eagles moved to Calusa Palms nest.
19-20	Inactive
20-21	Inactive