

SUBDIVISIONS

REVISIONS

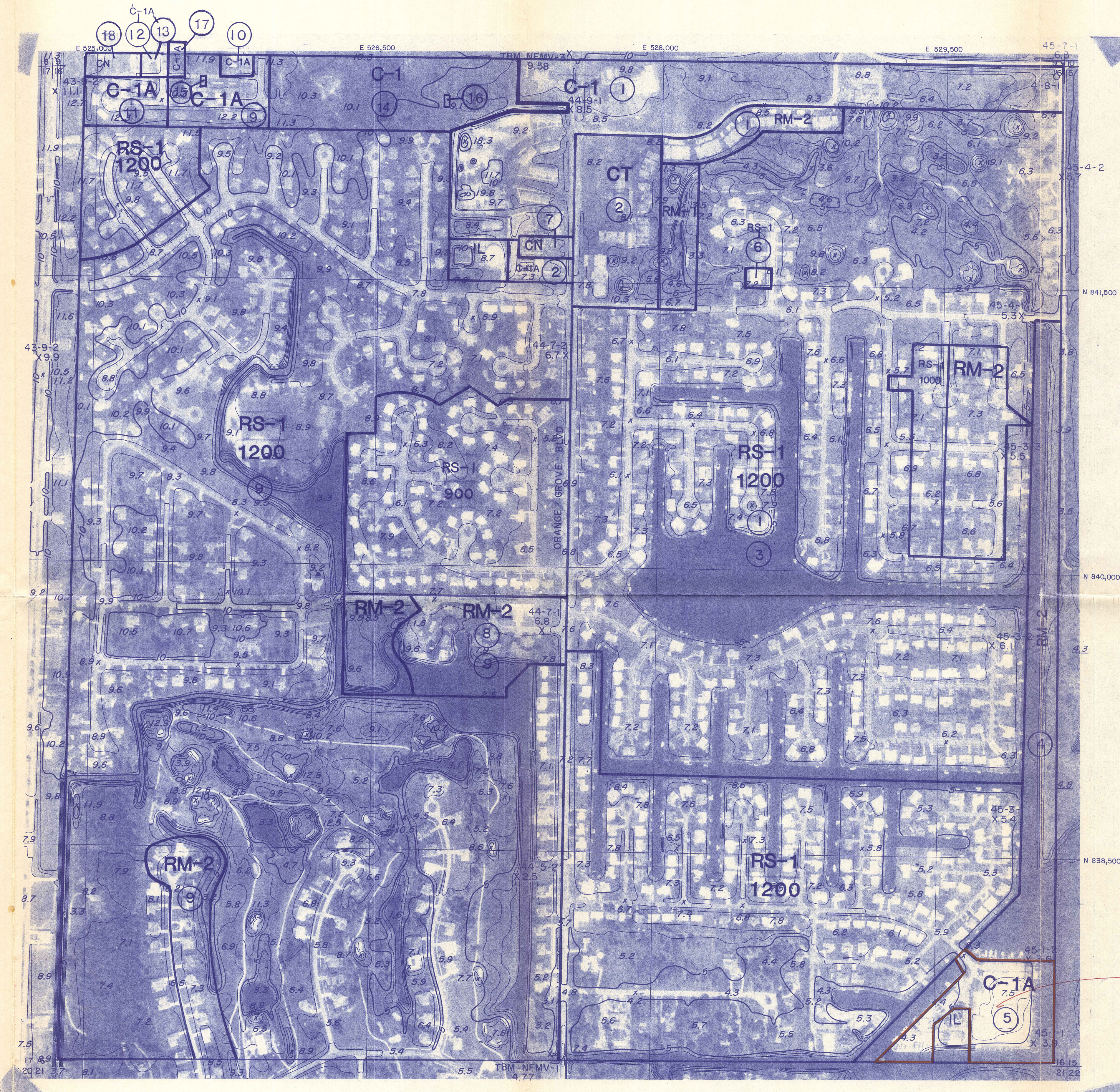

SUBJECT PROPERTY

THIS MAP DRAWN FOR VISUAL
PURPOSES ONLY. NOT TO BE USED
FOR OFFICIAL ZONING MAP

1. (12) 68-1-5 Special permit for beverage license in El Rio Club House
2. (101A) 77-3-3
3. (63) 63-9-2
4. (44) 64-5-6
5. (123) 76-6-23 Special permit for existing marina (see res.)
6. (265) 77-10-33 Variance of 10' rear setback for pool
7. (309) 79-11-16
8. (38) 65-5-1
9. (115) 72-4-23 See res. for special permits granted
10. (127) 79-5-24 Special exception for consumption on premises
11. (153) 79-5-42
12. (312) 78-11-14 Special exception for consumption on premises
13. (432) 81-9-38 Variances granted see res. for information
14. (182) 85-7-27 Variance to allow 6 ft. height continuous visual screen with stipulations. See resolutions.
15. (207) 85-8-14 Special exception for consumption on premises with conditions.
 1. spr. exp. be limited to Unit #6
 2. be limited to meals only
 3. adequate parking be demonstrated prior to occupancy permit
16. (35) 85-12-10 Special exception for consumption of alcoholic beverages on premises.
17. (35) 85-12-11 Special exception for consumption of alcoholic beverages on premises. Subject to the provision of proper parking.
18. (12612A) 85-1-13 District boundary change with a special exception for automobile service station (minor repairs only).

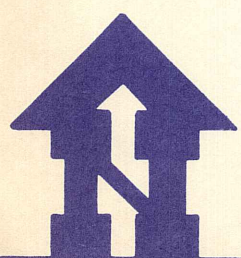

NOTE:
THIS SHEET DRAWN FOR VISUAL PURPOSES ONLY. DIMENSIONS SHOWN ARE TAKEN FROM LEGAL DESCRIPTIONS, WHEN POSSIBLE, BUT SECTION LINE DIMENSIONS ARE UNKNOWN. THEREFORE, DRAWING MAY NOT BE TO SCALE.

NOTE:
THIS MAP IS COMPILED FROM EXISTING D.O.T. APPRAISER AND ZONING MAPS OF LEE COUNTY. WHERE CONFLICT MAY EXIST, OFFICIAL RECORDS HELD BY LEE COUNTY SHALL BE THE FINAL AUTHORITY.

STATEMENT:
"THIS IS TO CERTIFY THAT THIS IS MAP OF _____ OF _____ OF THE OFFICIAL ZONING MAPS OF LEE COUNTY, FLORIDA.

SCALE
1" = 300'

OFFICIAL ZONING MAP

PREPARED BY: INFORMATION SERVICES DEPARTMENT

LEE COUNTY, FLORIDA

SECTION 16 TOWNSHIP 44 RANGE 24

88-10-11 DCE

E 531,000

N 844,000

N 844,000

N 842,500

N 841,000

N 839,500

N 838,000

N 836,500



E 523,500

E 525,000

E 526,500

E 528,000

E 529,500

E 531,000

LEGEND

HORIZONTAL CONTROL U.S.C. & G.S.
FLORIDA D.O.T. CONTROL
ESTABLISHED SECTION CORNER
GEODETIC CONTROL BY DENI ASSOC.
SECTION CORNER (APPROX. LOCATION)



36	31	32	33	34	35	36	31
1	6	5	4	3	2	1	6
12	7	8	9	10	11	12	7
13	18	17	16	15	14	13	18
24	19	20	21	22	23	24	19
25	30	29	28	27	26	25	30
26	31	32	33	34	35	36	31
1	6	5	4	3	2	1	6

KEY MAP



NOTE:

ACCURACY: IT IS INTENDED THAT THIS MAPPING COMPLY WITH U.S. NATIONAL MAP ACCURACY STANDARDS, HOWEVER SUCH ACCURACY OR ANY OTHER LEVEL OF ACCURACY IS NOT GUARANTEED BY LEE COUNTY, FLORIDA

LAND LINE INFORMATION SHOWN HERE ON IS COMPILED FROM THE BEST AVAILABLE DATA AND DOES NOT NECESSARILY REPRESENT TRUE LAND LINE LOCATION.

GRIDS BASED ON FLORIDA STATE PLANE COORDINATE SYSTEM, WEST ZONE.

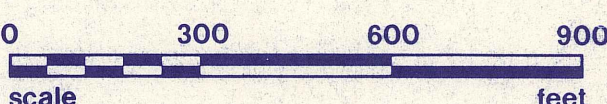

SCALE 1" = 300'

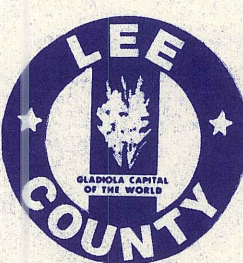

County of Lee
DEPARTMENT OF INFORMATION SERVICES
FORT MYERS, FLORIDA

SEC. 16 - T 44S - R 24 E

88-10-11 DCI