



COURTESY NOTICE TO ADJACENT PROPERTY OWNERS OF RECEIPT OF APPLICATION

Case Number: CPA2015-00003

Case Name: DUSTY METRO

Contact Person: Brandon D Dunn
(239) 533-8585

Request: APPLICATION FOR an amendment to the Future Land Use Map, Map 1, from Industrial Development and Wetlands to Urban Community and Wetlands and text amendment to Table 1(b)

Location: 6900 SHALOM LN, GATEWAY/AIRPORT PLANNING

PROPERTY OWNER'S REPRESENTATIVE: TINA M EKBLAD
MORRIS-DEPEW ASSOCIATES, INC.
239-3367-3993

The file may be reviewed Monday through Friday between the hours of 7:30 a.m. and 4:30 p.m. at the Lee County Planning Division, 1500 Monroe St., Fort Myers, FL 33901 or online at <http://www.leegov.com/dcd/planning/cpa> (click the appropriate plan amendment year and then on case number as noted above to access files). Call (239) 533-8585 for additional information.

This is a courtesy notice. Please review the News-Press for Local Planning Agency meeting notices or visit our web calendar at www.leegov.com/dcd/events to view available meeting agendas.

**CPA2015-03
Dusty Metro**

**Subject
Parcel**

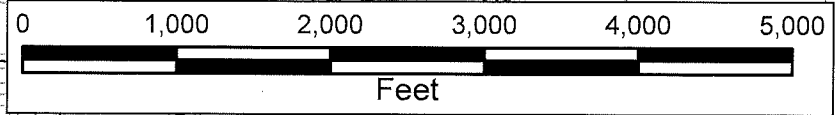
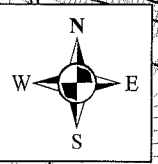
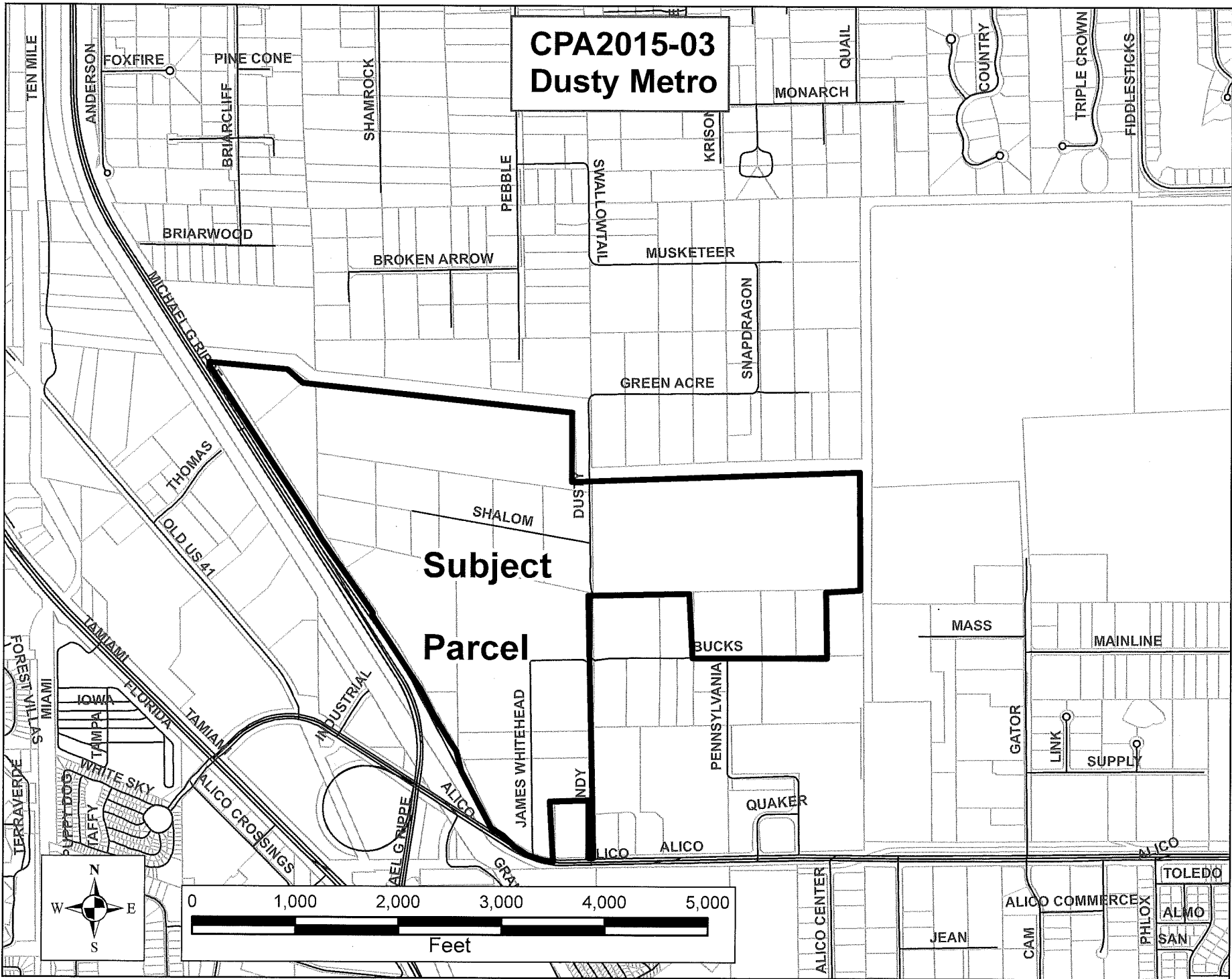

PROPERTY OWNERSHIP REPORT

Date of Report: 1/21/2015 9:35:17 AM

Parcels Affected: 0

Source: Lee County Property Appraiser

OWNER NAME AND ADDRESS	STRAP AND LOCATION	LEGAL DESCRIPTION
JAFFRAY JEFFREY A + LEONNA J 7150 GREEN ACRE LN FORT MYERS, FL 33912	05-46-25-00-00002.0020 7150 GREEN ACRE LN FORT MYERS FL 33912	COMM NE COR OF S 1/2 OF N 2/3 OF NW 1/4 SEC 5 TH W 1650 FT ALG N LI SD FRAC
SOARES LILLIAN F + 7100 GREEN ACRE LN FORT MYERS, FL 33912	05-46-25-00-00002.0030 7100 GREEN ACRE LN FORT MYERS FL 33912	BEG 660 FT M/L E OF SW COR OF N 2/3 NW 1/4 SEC 5 TH E 330 FT N 636.46 FT W
PAPNER DENNIS J + FRANCINE 7050 GREEN ACRE LN FORT MYERS, FL 33912	05-46-25-00-00002.0050 7050 GREEN ACRE LN FORT MYERS FL 33912	COMM NE COR OF S 1/2 OF N 2/3 OF NW 1/4 TH W 2310 FT TH S 636.41 FT TO POB TH
MUELLER ALFRED M 5753 ELIZABETH ANN WAY FORT MYERS, FL 33912	05-46-25-00-00002.0060 7200 GREEN ACRE LN FORT MYERS FL 33912	PARL IN NW 1/4 SEC 5 TWP 46 R 25 DESC IN OR551 PG336 LES OR2801/1009
MUELLER AL + SUZANNE 7200 GREEN ACRE LN FORT MYERS, FL 33912	05-46-25-00-00002.006A 7176 GREEN ACRE LN FORT MYERS FL 33912	PARL IN NW1/4 SEC 5 TWP 46 RGE 25 DESC OR 2801 PG 1009
EDMAN FRED M + KELLY J 7001 GREEN ACRE LN FORT MYERS, FL 33912	05-46-25-00-00002.0080 7001 GREEN ACRE LN FORT MYERS FL 33912	FR NE COR OF S 1/2 OF N 2/3 OF NW 1/4 RUN S 89 DEG 07 MIN 20 SEC W 2310 FT TO
VARGAS EDWIN 7300 GREEN ACRE LN FORT MYERS, FL 33912	05-46-25-00-00002.0110 7300 GREEN ACRE LN FORT MYERS FL 33912	FR NE COR OF S 1/2 OF N 2/3 OF NW 1/4 RUN W ALG N LI 990 FT TH S 636.61 FT LES 2.011A 2.011B + 2.0140
CORBITT JAMES 7350 GREEN ACRE LN FORT MYERS, FL 33912	05-46-25-00-00002.011A 7350 GREEN ACRE LN FORT MYERS FL 33912	FR NE COR OF S1/2 OF N2/3 OF NW1/4 W990FT S637FT E660FT TO POB AKA TR 24
VARGAS EDWIN 7300 GREEN ACRE LN FORT MYERS, FL 33912	05-46-25-00-00002.011B 7320 GREEN ACRE LN FORT MYERS FL 33912	PARL LOC IN NW 1/4 OF SECT AS DESC OR 4124/50
CHENEY MICHAEL E + MARY B 16211 DUSTY RD FORT MYERS, FL 33912	05-46-25-00-00002.0130 16211 DUSTY RD FORT MYERS FL 33912	PARL IN S 1/2 OF N 2/3 OF NW 1/4 DESC IN OR 1648 PG 1880
FIGUEIREDO SANDRO + 8500 COLONY TRACT DR FORT MYERS, FL 33908	05-46-25-00-00002.0140 7250 GREEN ACRE LN FORT MYERS FL 33912	FR NE COR OF S1/2 OF N2/3 OF NW1/4 W990 S636 TO POB DESC OR 2865 PG 1265
JAMES MANN PROPERTIES LLC 305 SW 3RD ST CAPE CORAL, FL 33991	05-46-25-00-00004.0010 7400 BUCKS LN FORT MYERS FL 33912	E.990 FT.OF S.660 FT OF NE 1/4 OF SW 1/4 LESS ROW DESC IN OR 3256 PG 3202
CS HOLDINGS OF SWFL PO BOX 07075 FORT MYERS, FL 33919	05-46-25-00-00004.0020 7050 PENNSYLVANIA ST FORT MYERS FL 33912	FR S.E.COR N 1/2 OF SW 1/4 RUN W ALG S LI N 1/2 OF SW 1/4 1320 FT TO POB.TH N.
UTLEY CYNTHIA R PO BOX 397 ESTERO, FL 33929	05-46-25-00-00004.0030 7050/7060 BUCKS LN FORT MYERS FL 33912	FR S.E.COR N 1/2 OF SW 1/4 RUN W ALG S LI N 1/2 SW 1/4 FOR 1320 FT TH N ALG
LOMBARDO INVESTING LLC 13931 EAGLE RIDGE DR UT 101 FORT MYERS, FL 33912	05-46-25-00-00004.0040 7200 BUCKS LN FORT MYERS FL 33912	PARL IN NW 1/4 OF S2 1/4 SEC 5 TWP 46 R 25 DESC IN OR 222 PG 25
JAMES MANN PROPERTIES LC 305 SW 3RD ST CAPE CORAL, FL 33991	05-46-25-00-00004.0050 7101 BUCKS LN FORT MYERS FL 33912	FR S.E.COR N 1/2 SW 1/4 RUN W ALG S LI N 1/2 SW 1/4 FOR 1320 FT TH N ALG
JAMES MANN PROPERTIES LLC 305 SW 3RD ST CAPE CORAL, FL 33991	05-46-25-00-00004.0070 7001 BUCKS LN FORT MYERS FL 33912	FR S.E. COR N 1/2 SW 1/4 RUN W ALG S LI N 1/2 SW 1/4 FOR 1320 FT TH N ALG

OWNER NAME AND ADDRESS	STRAP AND LOCATION	LEGAL DESCRIPTION
LEWIS EDWIN TED JR TR PMB 626 13300 S CLEVELAND AVE STE 56 FORT MYERS, FL 33907	05-46-25-00-00004.0080 7051 PENNSYLVANIA ST FORT MYERS FL 33912	FR SE COR N 1/2 OF SW 1/4 RUN S 88 DEG 56 MIN 30 SEC W ALG S LI N 1/2 990 FT TO
JOHNS GARY W + SUE L 1840 HILL AVE FORT MYERS, FL 33901	05-46-25-00-00004.0090 7000 BUCKS LN FORT MYERS FL 33912	FR THE SE COR OF N 1/2 OF SW 1/4 RUN W 1320 FT TH N 660 FT TH W 990 FT TO POB
CS HOLDINGS OF SWFL PO BOX 07075 FORT MYERS, FL 33919	05-46-25-00-00004.0110 7100 BUCKS LN FORT MYERS FL 33912	FR THE SE COR OF N 1/2 OF SW 1/4 RUN W 1320 FT N 660 FT W 330 FT TO POB.CONT.W
JAMES MANN PROPERTIES LLC 305 SW 3RD ST CAPE CORAL, FL 33991	05-46-25-00-00004.0130 7451 BUCKS LN FORT MYERS FL 33912	BEG 660 FT N OF SE COR N 1/2 OF SW 1/4 OF SEC TH N 654.64 FT W 330 FT S 655.8
CS HOLDINGS OF SWFL PO BOX 07075 FORT MYERS, FL 33919	05-46-25-00-00004.0140 7080 BUCKS LN FORT MYERS FL 33912	PARL LOC IN THE SW 1/4 DESC IN OR 3941 PG 4288
COMMUNITY ASPHALT CORP 9725 NW 117 AVE MIAMI, FL 33178	05-46-25-00-00005.0050 16560-591 MASS CT FORT MYERS FL 33912	PARL IN NW 1/4 OF SE 1/4 DESC IN OR 4189 PG 2947
N M C R INC 271 E OAKLAND PARK BLVD FORT LAUDERDALE, FL 33334	05-46-25-00-00007.0010 7011 ALICO RD FORT MYERS FL 33912	FR SW COR SEC 5 N 50 FT TO POB THEN N 436FT E 240FT S 436FT W 240 TO POB
COLVARD EARL W + PATRICIA B 2220 OAK HILL DR DELAND, FL 32720	05-46-25-00-00007.0020 7051 ALICO RD FORT MYERS FL 33912	FR SW COR OF SEC 5 N50FT TO NLY R/W OF ALICO RD E240FT TO POB DESC OR 3160/1837 + INST#2007-209223 LESS R/W OR 3185/4799
ALICO LAKESIDE LLC 26811 S BAY DR STE 350 BONITA SPRINGS, FL 34134	05-46-25-00-01000.5000 GATOR RD FORT MYERS FL 33912	PARCEL IN SE 1/4 AS DESC IN INST 2006-20190
ALICO LAKESIDE LLC 26811 S BAY DR STE 350 BONITA SPRINGS, FL 34134	05-46-25-00-01000.5070 ACCESS UNDETERMINED FORT MYERS FL	PARL LYING IN E 1/2 AS DESC IN INST#2006000020189 LESS INST#2007000328724
CS HOLDINGS OF SWFL LLC PO BOX 07075 FORT MYERS, FL 33919	05-46-25-02-00001.0000 7101 ALICO RD FORT MYERS FL 33912	KINZER PK OWENS 1ST ADDN PB 6 PG 28 BLKS A-J LESS OR 1857/1845 PAR 7.0 AREA 00 + OR 3203/308 + OR 3203/344
CROUCH S LEE TR 1/3 INT + 5260 SOUTH LANDINGS DR #704 FORT MYERS, FL 33919	06-46-25-00-00002.0000 ACCESS UNDETERMINED FORT MYERS FL	S 1/2 OF N 1/2 OF NW 1/4 LESS RR R/W + PARL 2.001 THRU 2.0030 LESS RD R/W OR 4003 PG 4804
GULF PAVING COMPANY INC PO BOX 1584 FORT MYERS, FL 33902	06-46-25-00-00003.0010 16351 OLD US 41 FORT MYERS FL 33912	FR NW COR OF S 1/2 OF NW 1/4 SEC 6 RUN S 00 DEG 22 MIN 47 SEC E 385.99 FT TH
REED PHILLIP W + JEAN M 3106 HIGHLANDS RD FRANKLIN, NC 28734	06-46-25-00-00003.0020 6290 THOMAS RD FORT MYERS FL 33912	FR NW COR OF S 1/2 OF NW 1/4 RUN S 00 DEG 22 MIN 47 SEC E 385.99 FT TH S 40
TOMAHAWK CONSTRUCTION LLC 15835 BROTHERS CT FORT MYERS, FL 33912	06-46-25-00-00003.0110 16651 OLD US 41 FORT MYERS FL 33912	PARL IN W 1/2 OF SEC 6 DESC IN OR 3697 PG 4948 LESS INST#2006-285776
PAGE PAUL K TR 2706 JUNONIA CT FORT MYERS, FL 33908	06-46-25-00-00003.0130 16701 OLD US 41 FORT MYERS FL 33912	PARL IN W 1/2 SEC 6 TWP 46 RGE 25 DESC IN OR 1477 PG 2151 + OR 1595 PG 2143 LESS OR 3697 PG 4948 + 2007000189606
LAND BARON III LLC BRIAN GORDON 1371 SAWGRASS CORPORATE PKWY SUNRISE, FL 33323	06-46-25-00-00003.0150 16605 OLD US 41 FORT MYERS FL 33912	PARL IN W 1/2 OF SEC 6 DESC IN INST#2006-285776
CSX TRANSPORTATION INC 500 WATER ST JACKSONVILLE, FL 32202	06-46-25-00-00004.0000 RAILROAD R/W FORT MYERS FL 33912	STRIP OF LAND RR R/W RUNNING SELY ACROSS SEC.
PRY RICHARD J 13807 PINE VILLA LN FORT MYERS, FL 33912	06-46-25-00-00005.0010 16299 S PEBBLE LN FORT MYERS FL 33912	PARL IN E 1/2 OF E 1/2 OF NE 1/4 DESC IN OR 3469 PG 3774
LEE COUNTY PO BOX 398 FORT MYERS, FL 33902	06-46-25-00-00005.001A 16100 RAINFOREST LN FORT MYERS FL 33912	PARL IN GLS 1 + 2 DESC IN OR 1371 PG 701

OWNER NAME AND ADDRESS	STRAP AND LOCATION	LEGAL DESCRIPTION
LEE COUNTY PO BOX 398 FORT MYERS, FL 33902	06-46-25-00-00005.001B 16270 SAWDUST TRL FORT MYERS FL 33912	FR SW COR GOVT LT 2 N 293. 75FT TH E 657.85 FT TO POB OR 2588 PG 3626
PRATER JOHN F + STACY B 6678 BROKEN ARROW RD FORT MYERS, FL 33912	06-46-25-00-00005.0030 6678 BROKEN ARROW RD FORT MYERS FL 33912	PARL IN N 1/2 OF N E 1/4 SEC 6 TWP 46 R 25 DESC IN OR 1216 PG 1385 LESS OR 2840/1031
SARNOWSKI EDWARD T 16160 RAINFOREST LN FORT MYERS, FL 33912	06-46-25-00-00005.008A 16160 RAINFOREST LN FORT MYERS FL 33912	PARL IN N 1/2 OF NE 1/4 DESC IN OR 1848 PG 3384 AKA TRACT 10 S 1/2
PROCE WILLIAM G + MAUREEN E 6640 BROKEN ARROW RD FORT MYERS, FL 33912	06-46-25-00-00005.0120 6640 BROKEN ARROW RD FORT MYERS FL 33912	PARL IN NE 1/4 SEC 06 TWP 46 R 25 DESC IN OR 1280 PG 0002 LESS OR 2840/1034
LISENBEЕ II ROBERT W 16300 S PEBBLE LN FORT MYERS, FL 33912	06-46-25-00-00005.0180 16300 S PEBBLE LN FORT MYERS FL 33912	FR NE COR OF SEC 6 S 1318FT TH W 968FT TH S222FT TO POB OR2959/797
CURRIER MICHAEL R + DOROTHY J 5920 GREY FOX RUN FORT MYERS, FL 33912	06-46-25-00-00005.0190 16250 S PEBBLE LN FORT MYERS FL 33912	FR NE COR SEC 6 S 1317FT TH W661FT TO POB DESC OR 2960 PG 4050
BAKER WILLIAM L 1/2 + 550 RIDGEWOOD LN CAMBRIDGE, OH 43725	06-46-25-00-00008.0010 6901 ALICO RD FORT MYERS FL 33912	W 360.3 FT OF E 390 FT OF S 630 FT OF SE 1/4 OF SEC LESS R/W
RENTCO HOLDINGS LLC PO BOX 7375 FORT MYERS, FL 33911	06-46-25-00-00010.0020 ALICO RD FORT MYERS FL 33912	PARL IN W 1/2 OF SE 1/4 ELY OF OLD US 41 DESC OR 1820 PT 3117 LESS OR 4104 PG 4378 + INST#2006-386640
SOVRAN ACQUISITION LP 6467 MAIN ST STE 200 BUFFALO, NY 14221	06-46-25-00-00010.0030 6600 INDUSTRIAL DR FORT MYERS FL 33912	PAR IN SE1/4 LYING SWLY OF ACL RR DESC OR 2722 PG 2851 AKA LOT 1
SOVRAN ACQUISITION LP 6467 MAIN ST STE 200 BUFFALO, NY 14221	06-46-25-00-00010.0040 6651 INDUSTRIAL DR FORT MYERS FL 33912	PAR IN SE1/4 LYING SWLY OF ACL RR DESC OR2722 PG2851 AKA LOT 1A
BEAUMONT WALTER CHAD + 2122 SEVILLA WAY NAPLES, FL 34109	06-46-25-00-00010.0050 RIGHT OF WAY FORT MYERS FL	PARL LOC IN THE SE 1/4 AS DESC IN OR 3284 PG 4317 LESS R/W OR 3851/2833
WHITEHEAD JAMES HOWARD TR 1622 VISCAYA PKWY CAPE CORAL, FL 33990	06-46-25-00-00010.0080 ALICO RD FORT MYERS FL 33912	PARL IN W 1/2 OF SE 1/4 ELY OF OLD US 41 DESC IN INST#2006-386640
STATE OF FL DOT PO BOX 1249 BARTOW, FL 33831	06-46-25-00-00011.0030 ACCESS UNDETERMINED FORT MYERS FL	PARL LOC IN SE 1/4 OF SECT DESC IN OR 4104 PG 4378 SWLY OF ALICO + NELY OF OLD US 41
STATE OF FL DOT PO BOX 1249 BARTOW, FL 33831	06-46-25-00-00011.0050 ACCESS UNDETERMINED FORT MYERS FL	PARL LOC IN SE 1/4 OF SECT DESC IN OR 4104 PG 4378 LYING NELY OF ALICO
SUNCOAST ALUMINUM FURNITURE 6291 THOMAS RD FORT MYERS, FL 33912	06-46-25-01-00000.0010 6291 THOMAS RD FORT MYERS FL 33912	BETTINELLI INDUSTRIAL S/D PB 41 PG 32 LOTS 1 + 2
KMC DEVELOPMENT OF SWFL LLC 4951 CEDAR HAMMOCK CT FORT MYERS, FL 33905	07-46-25-00-00006.0000 LAKE FORT MYERS FL 33967	PARL IN NE 1/4 SEC 7 AS DESC OR 2016 PG 4518 LES PAR 6.0060 LESS 4104/4399
UNITED CHRISTIAN GIVING INC 5845 RIVERSIDE LN FORT MYERS, FL 33919	07-46-25-00-00006.0010 6900 ALICO RD FORT MYERS FL 33912	PARL IN N E 1/4 DESC IN OR 2019 PG 1099
JODY DEVELOPMENT CORPORATION 68 BLUFF DR N WINCHESTER, TN 37398	07-46-25-00-00006.0060 6850 GRANADA LAKES DR FORT MYERS FL 33912	FR SE COR OF NE1/4 E FOR 603FT N32D W FOR 3060FT W 134FT TO POB
CSX TRANSPORTATION INC 500 WATER ST JACKSONVILLE, FL 32202	07-46-25-00-00016.0000 GRANADA LAKES DR FORT MYERS FL 33912	STRIP OF LAND RR R/W THRU E 1/2 NE 1/4
UNITED CHRISTIAN GIVING INC 5845 RIVERSIDE LN FORT MYERS, FL 33919	08-46-25-00-00001.0010 7118 ALICO RD FORT MYERS FL 33912	FR NW CORN OF SEC R S 50 TO POB-E1307 FT S 408 FT ETC LESS OR 2324/4228

05-46-25-00-00002.0020
JAFFRAY JEFFREY A + LEONNA J
7150 GREEN ACRE LN
FORT MYERS, FL 33912

05-46-25-00-00002.0030
SOARES LILLIAN F +
7100 GREEN ACRE LN
FORT MYERS, FL 33912

05-46-25-00-00002.0050
PAPNER DENNIS J + FRANCINE
7050 GREEN ACRE LN
FORT MYERS, FL 33912

05-46-25-00-00002.0060
MUELLER ALFRED M
5753 ELIZABETH ANN WAY
FORT MYERS, FL 33912

05-46-25-00-00002.006A
MUELLER AL + SUZANNE
7200 GREEN ACRE LN
FORT MYERS, FL 33912

05-46-25-00-00002.0080
EDMAN FRED M + KELLY J
7001 GREEN ACRE LN
FORT MYERS, FL 33912

05-46-25-00-00002.0110
VARGAS EDWIN
7300 GREEN ACRE LN
FORT MYERS, FL 33912

05-46-25-00-00002.011A
CORBITT JAMES
7350 GREEN ACRE LN
FORT MYERS, FL 33912

~~05-46-25-00-00002.011B
VARGAS EDWIN
7300 GREEN ACRE LN
FORT MYERS, FL 33912~~

05-46-25-00-00002.0130
CHENEY MICHAEL E + MARY B
16211 DUSTY RD
FORT MYERS, FL 33912

05-46-25-00-00002.0140
FIGUEIREDO SANDRO +
8500 COLONY TRACT DR
FORT MYERS, FL 33908

05-46-25-00-00004.0010
JAMES MANN PROPERTIES LLC
305 SW 3RD ST
CAPE CORAL, FL 33991

05-46-25-00-00004.0020
CS HOLDINGS OF SWFL
PO BOX 07075
FORT MYERS, FL 33919

05-46-25-00-00004.0030
UTLEY CYNTHIA R
PO BOX 397
ESTERO, FL 33929

05-46-25-00-00004.0040
LOMBARDO INVESTING LLC
13931 EAGLE RIDGE DR UT 101
FORT MYERS, FL 33912

~~05-46-25-00-00004.0050
JAMES MANN PROPERTIES LC
305 SW 3RD ST
CAPE CORAL, FL 33991~~

~~05-46-25-00-00004.0070
JAMES MANN PROPERTIES LLC
305 SW 3RD ST
CAPE CORAL, FL 33991~~

05-46-25-00-00004.0080
LEWIS EDWIN TED JR TR
PMB 626
13300 S CLEVELAND AVE STE 56
FORT MYERS, FL 33907

05-46-25-00-00004.0090
JOHNS GARY W + SUE L
1840 HILL AVE
FORT MYERS, FL 33901

~~05-46-25-00-00004.0110
CS HOLDINGS OF SWFL
PO BOX 07075
FORT MYERS, FL 33919~~

~~05-46-25-00-00004.0130
JAMES MANN PROPERTIES LLC
305 SW 3RD ST
CAPE CORAL, FL 33991~~

~~05-46-25-00-00004.0140
CS HOLDINGS OF SWFL
PO BOX 07075
FORT MYERS, FL 33919~~

05-46-25-00-00005.0050
COMMUNITY ASPHALT CORP
9725 NW 117 AVE
MIAMI, FL 33178

05-46-25-00-00007.0010
N M C R INC
271 E OAKLAND PARK BLVD
FORT LAUDERDALE, FL 33334

05-46-25-00-00007.0020
COLVARD EARL W + PATRICIA B
2220 OAK HILL DR
DELAND, FL 32720

05-46-25-00-01000.5000
ALICO LAKESIDE LLC
26811 S BAY DR STE 350
BONITA SPRINGS, FL 34134

~~05-46-25-00-01000.5070
ALICO LAKESIDE LLC
26811 S BAY DR STE 350
BONITA SPRINGS, FL 34134~~

~~05-46-25-02-00001.0000
CS HOLDINGS OF SWFL LLC
PO BOX 07075
FORT MYERS, FL 33919~~

06-46-25-00-00002.0000
CROUCH S LEE TR 1/3 INT +
5260 SOUTH LANDINGS DR #704
FORT MYERS, FL 33919

06-46-25-00-00003.0010
GULF PAVING COMPANY INC
PO BOX 1584
FORT MYERS, FL 33902

06-46-25-00-00003.0020
REED PHILLIP W + JEAN M
3106 HIGHLANDS RD
FRANKLIN, NC 28734

06-46-25-00-00003.0110
TOMAHAWK CONSTRUCTION LLC
15835 BROTHERS CT
FORT MYERS, FL 33912

06-46-25-00-00003.0130
PAGE PAUL K TR
2706 JUNONIA CT
FORT MYERS, FL 33908

06-46-25-00-00003.0150
LAND BARON III LLC
BRIAN GORDON
1371 SAWGRASS CORPORATE PKWY
SUNRISE, FL 33323

06-46-25-00-00004.0000
CSX TRANSPORTATION INC
500 WATER ST
JACKSONVILLE, FL 32202

06-46-25-00-00005.0010
PRY RICHARD J
13807 PINE VILLA LN
FORT MYERS, FL 33912

~~06-46-25-00-00005.001A
LEE COUNTY
PO BOX 398
FORT MYERS, FL 33902~~

~~06-46-25-00-00005.001B
LEE COUNTY
PO BOX 398
FORT MYERS, FL 33902~~

06-46-25-00-00005.0030
PRATER JOHN F + STACY B
6678 BROKEN ARROW RD
FORT MYERS, FL 33912

06-46-25-00-00005.008A
SARNOWSKI EDWARD T
16160 RAINFOREST LN
FORT MYERS, FL 33912

06-46-25-00-00005.0120
 PROCE WILLIAM G + MAUREEN E
 6640 BROKEN ARROW RD
 FORT MYERS, FL 33912

06-46-25-00-00011.0050
 STATE OF FL DOT
 PO BOX 1249
 BARTOW, FL 33831

06-46-25-00-00005.0180
 LISENBEE II ROBERT W
 16300 S PEBBLE LN
 FORT MYERS, FL 33912

06-46-25-01-00000.0010
 SUNCOAST ALUMINUM FURNITURE
 6291 THOMAS RD
 FORT MYERS, FL 33912

06-46-25-00-00005.0190
 CURRIER MICHAEL R + DOROTHY J
 5920 GREY FOX RUN
 FORT MYERS, FL 33912

07-46-25-00-00006.0000
 KMC DEVELOPMENT OF SWFL LLC
 4951 CEDAR HAMMOCK CT
 FORT MYERS, FL 33905

06-46-25-00-00008.0010
 BAKER WILLIAM L 1/2 +
 550 RIDGEWOOD LN
 CAMBRIDGE, OH 43725

07-46-25-00-00006.0010
 UNITED CHRISTIAN GIVING INC
 5845 RIVERSIDE LN
 FORT MYERS, FL 33919

06-46-25-00-00010.0020
 RENTCO HOLDINGS LLC
 PO BOX 7375
 FORT MYERS, FL 33911

07-46-25-00-00006.0060
 JODY DEVELOPMENT CORPORATION
 68 BLUFF DR N
 WINCHESTER, TN 37398

06-46-25-00-00010.0030
 SOVRAN ACQUISITION LP
 6467 MAIN ST STE 200
 BUFFALO, NY 14221

~~07-46-25-00-00016.0000
 CSX TRANSPORTATION INC
 500 WATER ST
 JACKSONVILLE, FL 32202~~

~~06-46-25-00-00010.0040
 SOVRAN ACQUISITION LP
 6467 MAIN ST STE 200
 BUFFALO, NY 14221~~

~~08-46-25-00-00001.0010
 UNITED CHRISTIAN GIVING INC
 5845 RIVERSIDE LN
 FORT MYERS, FL 33919~~

06-46-25-00-00010.0050
 BEAUMONT WALTER CHAD +
 2122 SEVILLA WAY
 NAPLES, FL 34109

06-46-25-00-00010.0080
 WHITEHEAD JAMES HOWARD TR
 1622 VISCAYA PKWY
 CAPE CORAL, FL 33990

~~06-46-25-00-00011.0030
 STATE OF FL DOT
 PO BOX 1249
 BARTOW, FL 33831~~