



LEE COUNTY
SOUTHWEST FLORIDA
BOARD OF COUNTY COMMISSIONERS

November 25, 2013

John E. Manning
District One

Cecil L. Pendergrass
District Two

Larry Kiker
District Three

Brian Hamman
District Four

Frank Mann
District Five

Roger Desjarlais
County Manager

Richard Wm. Wesch
County Attorney

Donna Marie Collins
Hearing Examiner

Ray Eubanks, Plan Processing Administrator
State Land Planning Agency
Caldwell Building
107 East Madison – MSC 160
Tallahassee, FL. 32399-0800

Re: Amendment to the Lee Plan
Transmittal Submission Package
Publicly Sponsored Amendments, CPA2013-03 and CPA2013-05

Dear Mr. Eubanks:

In accordance with the provisions of F.S. Chapter 163, please find attached the proposed Publicly Sponsored Comprehensive Plan amendments, known locally as CPA2013-03 and CPA2013-05. The proposed amendments are being submitted through the expedited state review process as described in Chapter 163.3184. The amendments are as follows:

CPA2013-03 is to amend Lee Plan Map 3F, Airport Layout Plan, for the Southwest Florida International Airport (RSW), to reflect the revised Airport Layout Plan (ALP) approved by the Federal Aviation Administration.

CPA2013-05 is to amend Policy 18.1.5, Policy 18.1.16, and Policy 18.2.2 to make the Lee Plan consistent with State requirements that prohibit local governments from requiring Development of Regional Impact (DRI) review for projects that don't meet or exceed state established thresholds.

The Local Planning Agency held a public hearing for the plan amendments on October 28, 2013. The Board of County Commissioners transmittal hearing for the plan amendments was held on November 18, 2013. The Board of County Commissioners voted to transmit the attached Lee Plan amendment packages at the November 18, 2013 transmittal hearing. The proposed amendments are not applicable to an area of critical state concern. The Board of County Commissioners has stated its intent to hold an adoption hearing following the receipt of the review agencies' comments.

The name, title, address, telephone number, facsimile number, and email address of the person for the local government who is most familiar with the proposed amendment is as follows:

Mr. Paul O'Connor, AICP
Lee County Planning Division Director
P.O. Box 398
Fort Myers, Florida 33902-0398

P.O. Box 398, Fort Myers, Florida 33902-0398 (239) 533-2111
Internet address <http://www.lee-county.com>
AN EQUAL OPPORTUNITY AFFIRMATIVE ACTION EMPLOYER

(239) 533-8309
Fax (239) 485-8319
Email: oconnops@leegov.com

Included with this package are one paper copy and two CD ROM copies, in PDF format, of the proposed amendment and supporting data and analysis. By copy of this letter and its attachments, I certify that this amendment and supporting data and analysis have been sent on this date to the agencies listed below.

Sincerely,

DEPT. OF COMMUNITY DEVELOPMENT
Division of Planning

A handwritten signature in black ink, appearing to read "Matthew W. For:", is written over the typed name and title of Paul O'Connor.

Paul O'Connor, AICP, Director
Director

All documents and reports attendant to this transmittal are also being sent, by copy of this cover in a CD ROM format, to:

Comprehensive Plan Review
Department of Agriculture and Consumer Services

Tracy D. Suber
Department of Education

Jim Quinn
Department of Environmental Protection

Susan Harp
Florida Department of State

Scott Sanders
Florida Fish and Wildlife Conservation Commission

Lawrence Massey
FDOT District One

Margaret Wuerstle
Southwest Florida Regional Planning Council

Terry Manning, A.I.C.P., Senior Planner, Intergovernmental Coordination Section
South Florida Water Management District

THE NEWS-PRESS
Published every morning
Daily and Sunday
Fort Myers, Florida
Affidavit of Publication

STATE OF FLORIDA
COUNTY OF LEE

Before the undersigned authority, personally appeared **Teri Halm** who on oath says that he/she is the **Legal Assistant** of the News-Press, a daily newspaper, published at Fort Myers, in Lee County, Florida; that the attached copy of advertisement, being a

Notice of Public Hearing

In the matter of: **Monday, November 18th.**

In the court was published in said newspaper in the issues of

November 8, 2013

Affiant further says that the said News-Press is a paper of general circulation daily in Lee, Charlotte, Collier, Glades and Hendry Counties and published at Fort Myers, in said Lee County, Florida and that said newspaper has heretofore been continuously published in said Lee County, Florida, each day, and has been entered as a second class mail matter at the post office in Fort Myers in said Lee County, Florida, for a period of one year next preceding the first publication of the attached copy of the advertisement; and affiant further says that he/she has neither paid nor promised any person, firm or corporation any discount, rebate, commission or refund for the purpose of securing this advertisement for publication in the said newspaper.

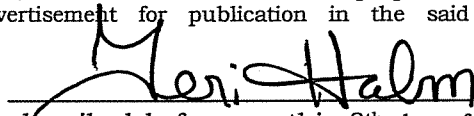

Sworn to and subscribed before me this 8th day of November, 2013.

by **Teri Halm**
personally known to me or who has produced

_____ as identification, and who did or did not take an oath.

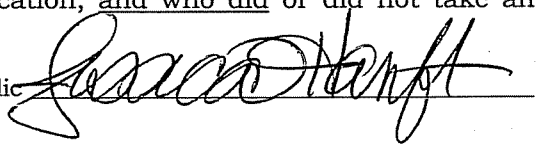
Notary Public 

Print Name: **Jessica Hanft**
My commission Expires: **February 12, 2017**



NOTICE OF PROPOSED AMENDMENTS TO THE LEE COUNTY COMPREHENSIVE LAND USE PLAN (TRANSMITTAL HEARING)

The Lee County Board of County Commissioners will hold a public hearing to consider proposed amendments to the Lee County Comprehensive Land Use Plan (Lee Plan) on Monday, November 18, 2013. The hearing will commence at 9:30 a.m., or as soon thereafter as can be heard, in the Board Chambers at 2120 Main Street in Downtown Fort Myers. At the hearing, the Board will consider the proposed amendments for transmittal to the Florida Department of Economic Opportunity:

A. CPA2013-00003 RSW Revised Airport Layout Plan - Map 3F

Amend Lee Plan Map 3F, the Southwest Florida International Airport, RSW, Airport Layout Plan, to reflect the revised Airport Layout Plan approved by the Federal Aviation Administration.

B. CPA2013-00005 University Community DRI Requirement

Amend Policy 18.1.5, Policy 18.1.16, Policy 18.1.16.6 and Policy 18.2.2 to make the Lee Plan consistent with State requirements that prohibit local governments from requiring Development of Regional Impact (DRI) review for projects that don't meet or exceed state established thresholds.

This transmittal hearing is the first step in a two step public hearing process to amend the Lee Plan. A second hearing will follow the Department of Economic Opportunity's review of the application.

Interested parties may appear at the meeting and be heard with respect to the proposed plan amendment.

A verbatim record of the proceeding will be necessary to appeal a decision made at this hearing. Contact the Lee

County Division of Planning at 239-533-8585 for further information on obtaining a record.

In accordance with the Americans with Disabilities Act, reasonable accommodations will be made upon request. Contact Janet Miller at 239-533-8583 No. 1480208 November 8, 2013

2013 NOV 12 PM 12:56
RECEIVED BY
LEE CO. ATTORNEY

**CPA2013-03
SOUTHWEST FLORIDA
INTERNATIONAL AIRPORT (RSW)
AIRPORT LAYOUT PLAN UPDATE,
MAP 3F
COMPREHENSIVE PLAN AMENDMENT
TO THE**

LEE COUNTY COMPREHENSIVE PLAN

THE LEE PLAN

Lee County Board of County Commissioners
Sponsored Amendment and Staff Analysis

DEO Transmittal Document

*Lee County Planning Division
1500 Monroe Street
P.O. Box 398
Fort Myers, FL 33902-0398
(239) 533-8585*

November 18, 2013

**LEE COUNTY
DIVISION OF PLANNING
STAFF REPORT FOR
COMPREHENSIVE PLAN AMENDMENT
CPA2013-03**

Text Amendment

Map Amendment

This Document Contains the Following Reviews	
✓	Staff Review
✓	Local Planning Agency Review and Recommendation
✓	Board of County Commissioners Hearing for Transmittal
	Staff Response to Review Agencies' Comments
	Board of County Commissioners Hearing for Adoption

STAFF REPORT PREPARATION DATE: October 17, 2013

PART I - BACKGROUND AND STAFF RECOMMENDATION

A. SUMMARY OF APPLICATION

1. APPLICANT/REPRESENTATIVES:

Lee County Board of County Commissioners/Lee County Port Authority staff and Division of Planning staff

2. REQUEST:

Amend Lee Plan Map 3F, Airport Layout Plan, for the Southwest Florida International Airport (RSW), to reflect the revised Airport Layout Plan (ALP) approved by the Federal Aviation Administration.

B. STAFF RECOMMENDATION AND FINDINGS OF FACT SUMMARY

1. RECOMMENDATION:

Staff recommends that the Board of County Commissioners *transmit* the proposed amendment to Map 3F of the Lee Plan.

2. BASIS AND RECOMMENDED FINDINGS OF FACT:

- The Lee County Board of County Commissioners initiated the proposed amendment on August 27, 2013 through Blue Sheet No. 20130718.
- The proposed amendment does not affect the airport boundaries as contained on the Lee Plan Future Land Use Map.
- The Federal Aviation Administration (FAA) has conditionally approved the Airport Layout Plan on August 30, 2011.
- Florida Statutes 163.3177(6)(b)2d and (b)4 provide that airport development that is addressed by local comprehensive plans that integrate airport layout plans does not constitute a development of regional impact.
- The last amendment to the Airport Layout Plan was adopted on September 22, 2004 by Lee Plan Amendment CPA2003-02.
- The proposed amendment provides sound planning coordination between Lee County staff and Port Authority staff.
- The proposed ALP includes new proposed locations for additional crossfield taxiways, the airport fire department and control tower.
- The proposed ALP depicts facilities that have been constructed since the adoption of CPA2003-02.

C. BACKGROUND INFORMATION

1. EXISTING CONDITIONS

SIZE OF PROPERTY: Airport property is approximately 6,372 acres.

PROPERTY LOCATION: The airport property is generally located on the east side of I-75, south of Daniels Parkway and north of Alico Road.

EXISTING LAND USE: The airport property is developed as an operating commercial airport.

CURRENT ZONING: The airport property is zoned Airport Operations Planned Development (AOPD).

CURRENT FUTURE LAND USE CATEGORY: The airport property has two Future Land Use designations: Airport and Wetlands.

2. INFRASTRUCTURE AND SERVICES:

FIRE: Lee County Port Authority Aircraft Rescue and Fire.

EMS: Lee County EMS service area.

LAW ENFORCEMENT: Airport Police and Security.

SOLID WASTE: The subject site is located in solid waste Service Area 3 and is serviced by Waste Pro.

MASS TRANSIT: LeeTran Route 50 provides regular service to the Southwest Florida International Airport.

WATER AND SEWER: The subject site is located within the Lee County water and sewer Future Service Areas as identified on Maps 6 and 7 of the Lee Plan.

PART II - STAFF ANALYSIS

A. STAFF DISCUSSION

INTRODUCTION

Lee County Port Authority staff, on May 7, 2013, provided to Division of Planning staff materials, including a revised ALP and a letter and report that describes changes that have been made to the ALP. The letter requests that the revised ALP be incorporated into the Lee Plan. The letter provides the following summary concerning the proposed change for the subject property:

The Lee County Port Authority has recently completed a multi-year planning and design analysis for the future parallel runway. As a result of the extensive alternatives analysis undertaken during this program a slight modification to the proposed runway layout and associated facilities as depicted on the 2004 ALP was determined to provide the most flexibility for future and ultimate airport development. These minor design changes were submitted to the FAA and subsequently approved on August 30, 2011.

Staff proposed to expedite the replacement of Map 3F with the updated and FAA approved ALP. The Lee County Board of County Commissioners initiated the proposed amendment on August 27, 2013 through Blue Sheet No. 20130718.

COMPREHENSIVE PLAN BACKGROUND

Lee Plan future land use designations for the airport property have changed over time as the Plan has been amended and the airport expanded. The current designation for RSW property is Airport and Wetlands

Recent changes include the ALP which was first adopted into the Lee Plan as Map 3F by Comprehensive Plan amendment CPA2003-02. It incorporated the results of the Airport

Master Plan process that was ongoing at the time. Lee Plan Amendment CPA2005-10 amended the Airport Noise Zones. Lee Plan Amendments CPA2007-57 and CPA2010-08 amended policies relating to development within the airport boundaries.

SURROUNDING ZONING, LAND USES, & FUTURE LAND USE CATEGORIES

The surrounding future land use categories consist of New Community, Tradeport, DR/GR, Wetlands, and Conservation Lands. The New Community designated lands are located to the northeast, on the north side of Daniels Parkway. The Tradeport designated lands are located to the north, on the north side of Daniels Parkway, to the west of the subject site across Treeline Avenue, and along the western end of the south boundary of the airport property. Along the eastern end of the southern boundary of the airport are lands designated as DR/GR, Wetlands, and Conservation Lands.

The Southwest Florida International Airport is zoned Airport Operations Planned Development (AOPD). East of the subject property is vacant AG-2 zoned land. West of the subject site are partly developed properties in the Tradeport future land use category that are zoned IPD, CPD, MPD and AG-2. North of Daniels Parkway within the Tradeport future land use category are industrial, commercial and vacant properties zoned CPD, IPD, MPD, AG-2, CC, CT, and IL. This includes the site of the new Boston Red Sox stadium. Northeast of the subject site, north of Daniels Parkway in the New Community future land use category is the Gateway Community, with a mix of commercial, light industrial and residential development zoned MPD and PUD.

PROPOSED CHANGES TO THE ALP

The revised ALP contains five changes from what is currently depicted on Map 3F of the Lee Plan. The first change is the shift of the new parallel runway (6R/24L) eighty feet to the south from its proposed location on the previous ALP. Second, a third crossfield taxiway for commercial aircraft has been proposed for the new ALP. This additional taxiway will allow the airport to maintain unrestricted operations. Third and fourth, the location of the future fire department and control tower are shifted from the currently depicted Map 3F. This is to accommodate the additional third crossfield taxiway. The proposed new location of the control tower is intended to provide proper visibility of the airport after completion of the second runway. The proposed new location of the fire department will allow quick access to both the existing runway and the future parallel runway. Fifth, the proposed ALP now depicts existing facilities that have been constructed since the adoption of the 2004 ALP. This includes the midfield terminal and its apron and taxiway, long term and employee parking, detention areas and other facilities.

EFFECT OF THE PROPOSED CHANGES

The proposed shift of the 6R/24L runway will provide the airport with an unconstrained commercial aircraft runway and parallel taxiway. The eighty foot shift also creates more area for the future Concourse A terminal. Although the shift places the proposed runway closer to FPL power lines, an analysis performed during the design process showed no conflict. The relocation of the control tower and fire department will allow them to better

operate within the airport. None of these internal operational changes cause an increase in the offsite impacts of the airport and therefore, no additional mitigation to public services is required.

B. STAFF RECOMMENDATION

County staff recommends that the Board of County Commissioners *transmit* the proposed amendment to Lee Plan Map 3F.

**PART III - LOCAL PLANNING AGENCY
REVIEW AND RECOMMENDATION**

DATE OF PUBLIC HEARING: October 28, 2013

A. LOCAL PLANNING AGENCY REVIEW

Staff gave a brief presentation regarding the proposed amendment. No members of the LPA had any comments concerning the amendment. No members of the public spoke, appeared, or addressed the proposed plan amendment.

B. LOCAL PLANNING AGENCY RECOMMENDATION AND FINDINGS OF FACT SUMMARY

1. RECOMMENDATION:

The LPA recommends that the Lee County Board of County Commissioners *transmit* the proposed Lee Plan amendment as recommended by staff.

2. BASIS AND RECOMMENDED FINDINGS OF FACT:

The LPA accepted the basis and recommended findings of fact as advanced by staff.

C. VOTE:

NOEL ANDRESS	<u>AYE</u>
STEVE BRODKIN	<u>AYE</u>
WAYNE DALTRY	<u>AYE</u>
JIM GREEN	<u>AYE</u>
MITCH HUTCHCRAFT	<u>AYE</u>
ANN PIERCE	<u>AYE</u>
ROGER STRELOW	<u>AYE</u>

**PART IV - BOARD OF COUNTY COMMISSIONERS
HEARING FOR TRANSMITTAL OF PROPOSED AMENDMENT**

DATE OF TRANSMITTAL HEARING: November 18, 2013

A. BOARD REVIEW:

Staff provided a brief overview of the proposed amendment. The Board of County Commissioners did not make any comments or have any questions concerning the proposed amendment. No members of the public addressed the Board of County Commissioners concerning the proposed amendment.

A motion was made to transmit the proposed amendment. The motion passed 5-0.

B. BOARD ACTION AND FINDINGS OF FACT SUMMARY:

1. **BOARD ACTION:** The Board of County Commissioners transmitted the proposed amendment as recommended by staff.

2. **BASIS AND RECOMMENDED FINDINGS OF FACT:** The Board of County Commissioners accepted the findings of fact as advanced by staff and the LPA.

C. VOTE:

BRIAN HAMMAN	<u>AYE</u>
LARRY KIKER	<u>AYE</u>
FRANK MANN	<u>AYE</u>
JOHN MANNING	<u>AYE</u>
CECIL L PENDERGRASS	<u>AYE</u>

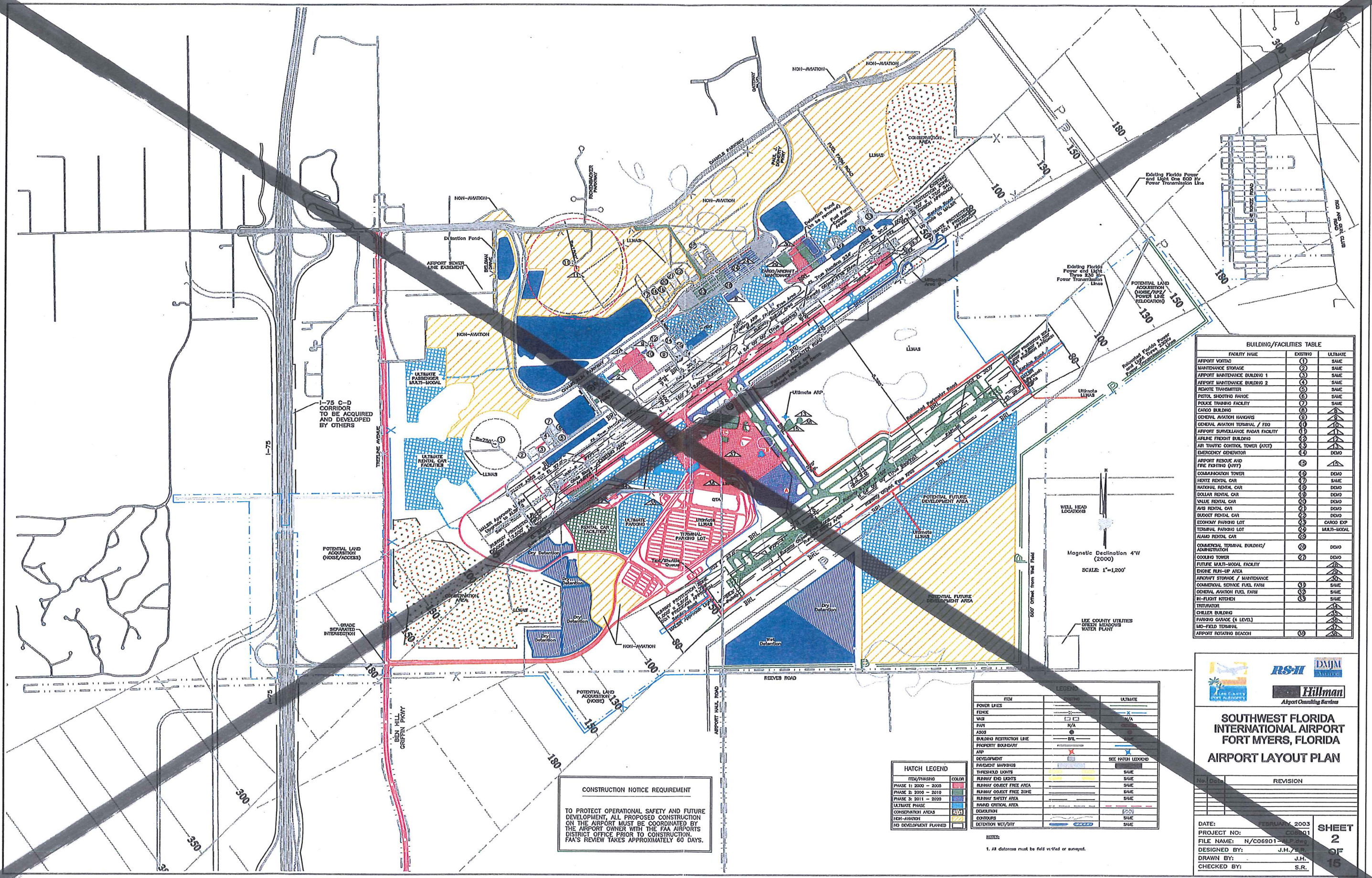

BUILDING/FACILITIES TABLE

FACILITY NAME	EXISTING	ULTIMATE
AIRPORT VORTOX	(1)	SALE
MAINTENANCE STORAGE	(2)	SALE
AIRPORT MAINTENANCE BUILDING 1	(3)	SALE
AIRPORT MAINTENANCE BUILDING 2	(4)	SALE
REMOTE TRANSMITTER	(5)	SALE
RIFLE SHOOTING RANGE	(6)	SALE
POLICE TRAINING FACILITY	(7)	SALE
CARGO BUILDING	(8)	SALE
GENERAL AVIATION HANGARS	(9)	SALE
GENERAL AVIATION TERMINAL / FBO	(10)	SALE
AIRPORT SURVEILLANCE RADAR FACILITY	(11)	SALE
AIRLINE FREIGHT BUILDING	(12)	SALE
AIR TRAFFIC CONTROL TOWER (ATCT)	(13)	SALE
EMERGENCY GENERATOR	(14)	DEMOL
AIRPORT RESCUE AND FIRE FIGHTING (ARFF)	(15)	DEMOL
COMMUNICATION TOWER	(16)	DEMOL
HERTZ RENTAL CAR	(17)	SALE
NATIONAL RENTAL CAR	(18)	DEMOL
DOLLAR RENTAL CAR	(19)	DEMOL
VALISE RENTAL CAR	(20)	DEMOL
AVIS RENTAL CAR	(21)	DEMOL
BUDGET RENTAL CAR	(22)	DEMOL
ECONOMY PARKING LOT	(23)	CARGO EXP
TERMINAL PARKING LOT	(24)	MULTI-MODAL
ALAMO RENTAL CAR	(25)	DEMOL
COMMERCIAL TERMINAL BUILDING / ADMINISTRATION	(26)	DEMOL
COLLEGE TOWER	(27)	DEMOL
FUTURE MULTI-MODAL FACILITY	(28)	DEMOL
DIKNE FLUR-UP AREA	(29)	DEMOL
AIRPORT STORAGE / MAINTENANCE	(30)	DEMOL
COMMERCIAL SERVICE FUEL FARM	(31)	SALE
GENERAL AVIATION FUEL FARM	(32)	SALE
BI-FLIGHT KITCHEN	(33)	SALE
TERMINAL	(34)	DEMOL
COLLEGE BUILDING	(35)	DEMOL
PARKING GARAGE (4 LEVEL)	(36)	DEMOL
LEO-FIELD TERMINAL	(37)	DEMOL
AIRPORT ROTATING BEACON	(38)	DEMOL

LEGEND

ITEM	SYMBOL	ULTIMATE
POWER LINES	---	---
FENCE	---	---
WASI	---	---
PAVE	---	---
ASCS	---	---
BUILDING RESTRICTION LINE	---	---
PROPERTY BOUNDARY	---	---
APP	---	---
DEVELOPMENT	---	SEE HATCH LEGEND
PROTECTIVE BARRIERS	---	---
THRESHOLD LIGHTS	---	---
RUNWAY END LIGHTS	---	---
RUNWAY OBJECT FREE AREA	---	---
RUNWAY OBJECT FREE ZONE	---	---
RUNWAY SAFETY AREA	---	---
PAVED CRITICAL AREA	---	---
DEMOLITION	---	---
CONTIGUOUS	---	---
DETENTION WET/DRY	---	---

HATCH LEGEND

ITEM/PHASIS	COLOR
PHASE 1: 2000 - 2005	Red
PHASE 2: 2005 - 2010	Blue
PHASE 3: 2011 - 2020	Green
ULTIMATE PHASE	Yellow
CONSERVATION AREA	Green with dots
NON-AVIATION	Blue with dots
NO DEVELOPMENT PLANNED	White

CONSTRUCTION NOTICE REQUIREMENT

TO PROTECT OPERATIONAL SAFETY AND FUTURE DEVELOPMENT, ALL PROPOSED CONSTRUCTION ON THE AIRPORT MUST BE COORDINATED BY THE AIRPORT OWNER WITH THE FAA AIRPORTS DISTRICT OFFICE PRIOR TO CONSTRUCTION. FAA'S REVIEW TAKES APPROXIMATELY 60 DAYS.

WELL HEAD LOCATIONS

Magnetic Declination 4'W (2000)

SCALE: 1"=1,200'

LEE COUNTY UTILITIES GREEN MEADOWS WATER PLANT

**SOUTHWEST FLORIDA INTERNATIONAL AIRPORT
FORT MYERS, FLORIDA
AIRPORT LAYOUT PLAN**

DATE: FEBRUARY 2003
PROJECT NO: C06901
FILE NAME: N/C06901-ALP.dwg
DESIGNED BY: J.H.
DRAWN BY: J.H.
CHECKED BY: S.R.

SHEET 2 OF 15

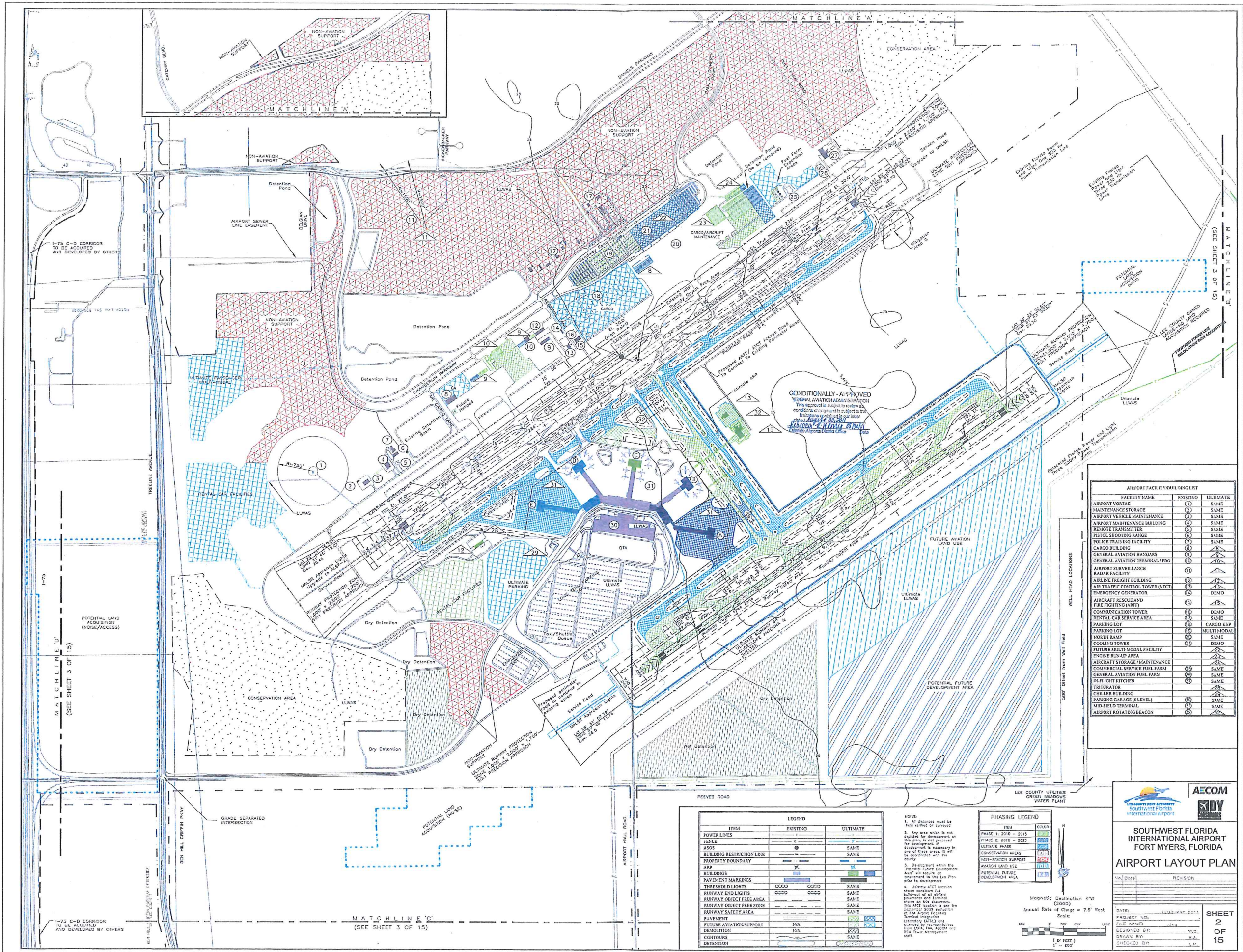

ITEM	EXISTING	ULTIMATE
POWER LINES	---	---
FENCE	---	---
ASPS	---	SAME
BUILDING RESTRICTION LINE	---	SAME
PROPERTY BOUNDARY	---	---
ARS	---	---
BUILDINGS	---	---
PAVEMENT MARKINGS	---	---
THRESHOLD LIGHTS	OOOO	OOOO
BURWAY END LIGHTS	OOOO	OOOO
BURWAY OBJECT FREE ZONE	---	SAME
BURWAY OBJECT FREE ZONE	---	SAME
BURWAY SAFETY AREA	---	SAME
PAVEMENT	---	---
FUTURE AVIATION SUPPORT	N/A	---
DEMOLITION	---	---
CONTOURS	---	SAME
DETENTION	---	---

NOTES:
 1. All distances must be field verified or surveyed.
 2. Any operation to be developed for development in this area, to not proceed for development, is subject to the approval of the FAA. It will be coordinated with the county.
 3. Development within the "Potential Future Development Area" will require an approval by the Lee Plan prior to development.
 4. Ultimate ATCT location shown here is a "best-guess" of a proposed location. This ATCT location is not the location of the ATCT as of the date of this plan. The ATCT location is subject to change based on FAA Airport Facility Development Plan and other factors. The ATCT location is shown here for informational purposes only. The ATCT location is not to be used for any other purpose.

ITEM	COLOR
PHASE 1: 2010 - 2015	Light Blue
PHASE 2: 2015 - 2020	Medium Blue
ULTIMATE PHASE	Dark Blue
CONSERVATION AREAS	Green
NON-AVIATION SUPPORT	Yellow
POTENTIAL LAND USE	Light Green
POTENTIAL FUTURE DEVELOPMENT AREA	Light Blue

AIRPORT FACILITY/BUILDING LIST		
FACILITY NAME	EXISTING	ULTIMATE
AIRPORT VEHICLE MAINTENANCE STORAGE	(1)	SAME
AIRPORT VEHICLE MAINTENANCE	(2)	SAME
AIRPORT MAINTENANCE BUILDING	(3)	SAME
REMOTE TRANSMITTER	(4)	SAME
PISTOL SHOOTING RANGE	(5)	SAME
POLICE TRAINING FACILITY	(6)	SAME
CARGO BUILDING	(7)	SAME
GENERAL AVIATION HANGARS	(8)	SAME
GENERAL AVIATION TERMINAL/FBO	(9)	SAME
AIRPORT SURVEILLANCE RADAR FACILITY	(10)	SAME
AIRLINE FREIGHT BUILDING	(11)	SAME
AIR TRAFFIC CONTROL TOWER (ATCT)	(12)	SAME
EMERGENCY GENERATOR	(13)	DEMO
AIRCRAFT RESCUE AND FIRE FIGHTING (ARFF)	(14)	SAME
CONDENSATION TOWER	(15)	DEMO
RENTAL CAR SERVICE AREA	(16)	SAME
PARKING LOT	(17)	CARGO EXP
PARKING LOT	(18)	MULTI-MODAL
NORTH RAMP	(19)	SAME
COOLING TOWER	(20)	DEMO
FUTURE MULTI-MODAL FACILITY	(21)	DEMO
ENGINE RUN-UP AREA	(22)	SAME
AIRCRAFT STORAGE/MAINTENANCE	(23)	SAME
COMMERCIAL SERVICE FUEL FARM	(24)	SAME
GENERAL AVIATION FUEL FARM	(25)	SAME
IN-FLIGHT KITCHEN	(26)	SAME
TRITURATOR	(27)	SAME
CHILLER BUILDING	(28)	SAME
PARKING GARAGE (3 LEVEL)	(29)	SAME
MID-FIELD TERMINAL	(30)	SAME
AIRPORT ROTATING BEACON	(31)	SAME

AECOM
SIDY
 LEWIS & CLARK ARCHITECTS
 SOUTH WEST FLORIDA INTERNATIONAL AIRPORT

**SOUTHWEST FLORIDA INTERNATIONAL AIRPORT
 FORT MYERS, FLORIDA
 AIRPORT LAYOUT PLAN**

DATE: FEBRUARY 2011
 PROJECT NO.:
 FILE NAME:
 DESIGN BY:
 DRAWN BY:
 CHECKED BY:

SHEET 2 OF 15

MAP 3F