



U.S. Department
of Transportation
**Federal Aviation
Administration**

Received
9/9/11

Orlando Airports District Office
5950 Hazeltine National Dr., Suite 400
Orlando, FL 32822-5003

Phone: (407) 812-6331

Fax: (407) 812-6978

August 31, 2011

Ms. Juliet S. Iglesias
Lee County Port Authority
Southwest Florida International Airport
11000 Terminal Access Road, Ste 8671
Fort Myers, Florida 33913-8899

XC: Ellen L. (w/ALP)
AECOM (w/ALP)

Dear Ms. Iglesias:

RE: Southwest Florida International Airport (RSW;) Ft. Myers, Florida
Conditional Airport Layout Plan Approval

The Federal Aviation Administration (FAA) conditionally approves your Airport Layout Plan (ALP) for Southwest Florida International Airport, dated August 30, 2011. This approval is subject to the condition that the proposed airport development listed below requires environmental processing and may not be undertaken without the FAA's prior written environmental approval.

Any development requiring environmental analysis in accordance with FAA Order 5050.4B.

FAA approval of your ALP means that all existing and proposed airport development shown on the plan meets current FAA Airport Design Standards or a current FAA approved Modification of Airport Design Standards. It also means that we find the proposed airport development shown on the plan useful and efficient. However, our approval does not represent a commitment to provide federal financial assistance to implement any development or air navigation facilities shown on the plan, nor does it mean that we find funding of the proposed airport development justified.

Please be aware that you are required to notify this office at least 60 days prior to the start of construction of any facilities on the airport. Also, this conditional ALP approval does not constitute airspace approval for aircraft parking aprons or structures. Prior to the start of construction of these facilities, you must submit proper notification to our office and receive FAA airspace approval. Furthermore, the design and location of any stormwater retention/detention facilities on or near the airport must comply with FAA Advisory Circular 150/5200-33, "Hazardous Wildlife Attractants on or Near Airports", and must be approved on the ALP prior to construction.

We look forward to working with you in the continued development of your airport.

Sincerely,

A handwritten signature in black ink that reads "Rebecca R. Henry". The signature is written in a cursive style with a large initial 'R'.

Rebecca R. Henry
Program Manager

Enclosure

cc:

AJV-E2 (w/3ALPs)

AJW-E-15C (w/ALP)

AJW-3742 (w/ALP)

Courtney Nolan, AJW-E11D (w/ALP)

ASO-290 (w/ALP)

FDOT/ 1 w/ALP

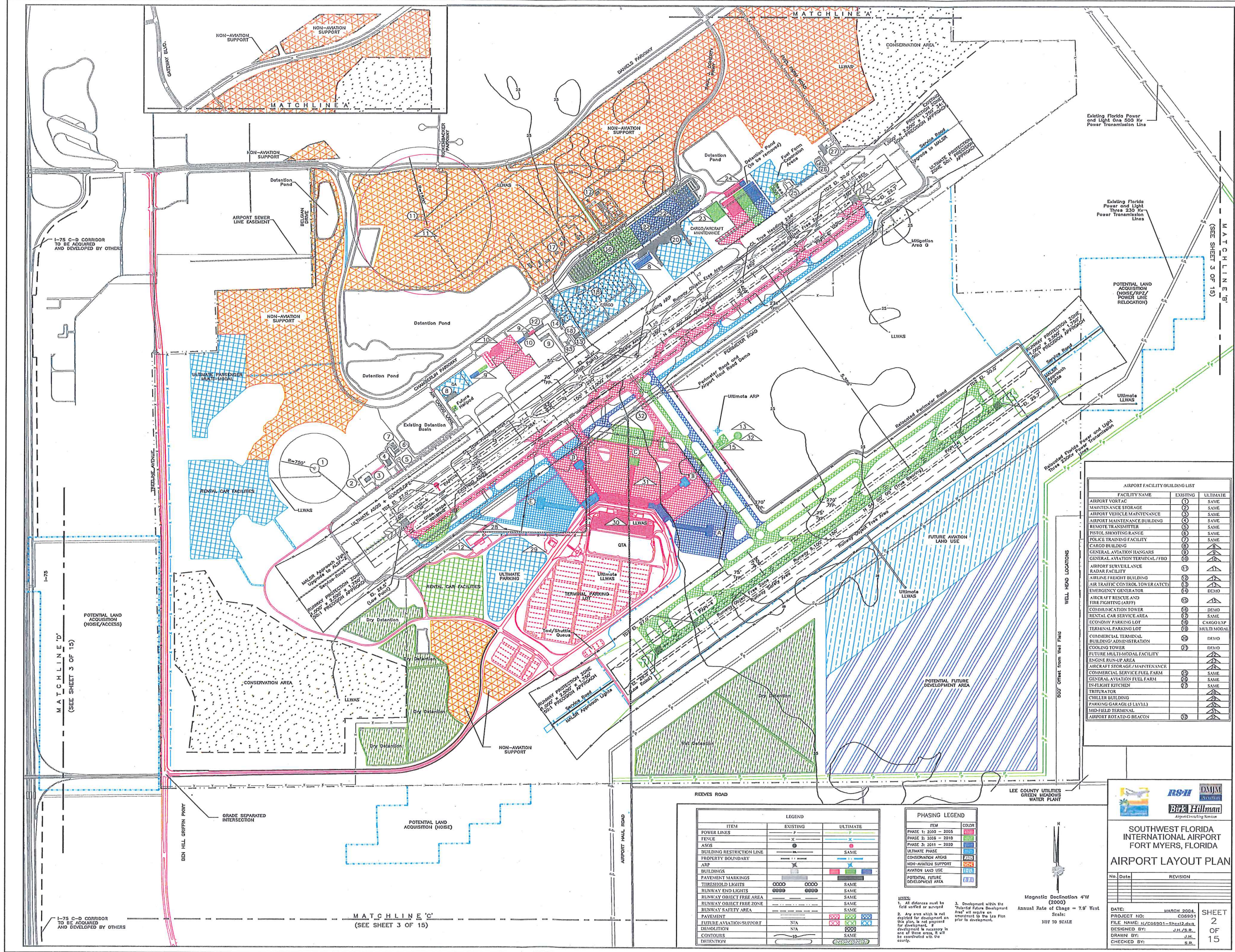

AIRPORT FACILITY/BUILDING LIST		
FACILITY NAME	EXISTING	ULTIMATE
AIRPORT VORTAC	1	SAME
MAINTENANCE STORAGE	2	SAME
AIRPORT VEHICLE MAINTENANCE	3	SAME
AIRPORT MAINTENANCE BUILDING	4	SAME
REMOTE TRANSMITTER	5	SAME
RIFLE SHOOTING RANGE	6	SAME
POLICE TRAINING FACILITY	7	SAME
CARGO BUILDING	8	6
GENERAL AVIATION HANGARS	9	6
GENERAL AVIATION TERMINAL/FBO	10	10
AIRPORT SERVICE BUILDING	11	11
RADAR FACILITY	12	12
AIRLINE FREIGHT BUILDING	13	13
AIR TRAFFIC CONTROL TOWER (ATCT)	14	14
EMERGENCY GENERATOR	15	DEMO
AIRCRAFT RESCUE AND FIRE FIGHTING (ARFF)	16	DEMO
COMMUNICATION TOWER	17	DEMO
RENTAL CAR SERVICE AREA	18	SAME
ECONOMY PARKING LOT	19	CARGO EXP
TERMINAL PARKING LOT	20	MULTI-MODAL
COMMERCIAL TERMINAL BUILDING ADMINISTRATION	21	DEMO
COOLING TOWER	22	DEMO
FUTURE MULTI-MODAL FACILITY	23	23
ENGINE RUN-UP AREA	24	24
AIRCRAFT STORAGE/MAINTENANCE	25	SAME
COMMERCIAL SERVICE FUEL FARM	26	SAME
GENERAL AVIATION FUEL FARM	27	SAME
IN-FLIGHT KITCHEN	28	SAME
TRIPTRATOR	29	29
CHILLER BUILDING	30	30
PARKING GARAGE (4 LEVEL)	31	31
MID-FIELD TERMINAL	32	32
AIRPORT ROTATING BEACON	33	33

ITEM	EXISTING	ULTIMATE
POWER LINES	—	—
FENCE	—	—
ASIS	—	—
BUILDING RESTRICTION LINE	—	SAME
PROPERTY BOUNDARY	—	—
ARP	—	—
BUILDINGS	—	—
PAVEMENT MARKINGS	—	—
THRESHOLD LIGHTS	—	SAME
RUNWAY END LIGHTS	—	SAME
RUNWAY OBJECT FREE AREA	—	SAME
RUNWAY SAFETY AREA	—	SAME
PAVEMENT	—	—
FUTURE AVIATION-SUPPORT	N/A	—
DEMOLITION	N/A	—
CONTOURS	—	—
DETENTION	—	—

ITEM	COLOR
PHASE 1: 2005 - 2010	Light Blue
PHASE 2: 2011 - 2015	Light Green
PHASE 3: 2016 - 2020	Light Orange
ULTIMATE PHASE	Light Purple
CONSERVATION AREAS	Light Yellow
NON-AVIATION SUPPORT	Light Cyan
AIRPORT LAND USE	Light Blue
POTENTIAL FUTURE DEVELOPMENT AREA	Light Green

NOTES:
 1. All distances must be field verified or surveyed.
 2. Any area which is not designated for development on this plan, is not proposed for development. If development is necessary in any of these areas, it shall be coordinated with the county.
 3. Development within the "Potential Future Development Area" will require a "Future Development Area" prior to development.

Magnetic Declination 4'W (2000)
 Annual Rate of Change = 7.6' West
 Scale: 1" = 100'
 100' TO SCALE

**SOUTHWEST FLORIDA INTERNATIONAL AIRPORT
 FORT MYERS, FLORIDA
 AIRPORT LAYOUT PLAN**

DATE: MARCH 2004
 PROJECT NO: C06901
 FILE NAME: N:\C06901-Sheet2.dwg
 DESIGNED BY: J.H./S.B.
 DRAWN BY: J.H.
 CHECKED BY: S.B.

REVISION

No. Date

SHEET 2 OF 15

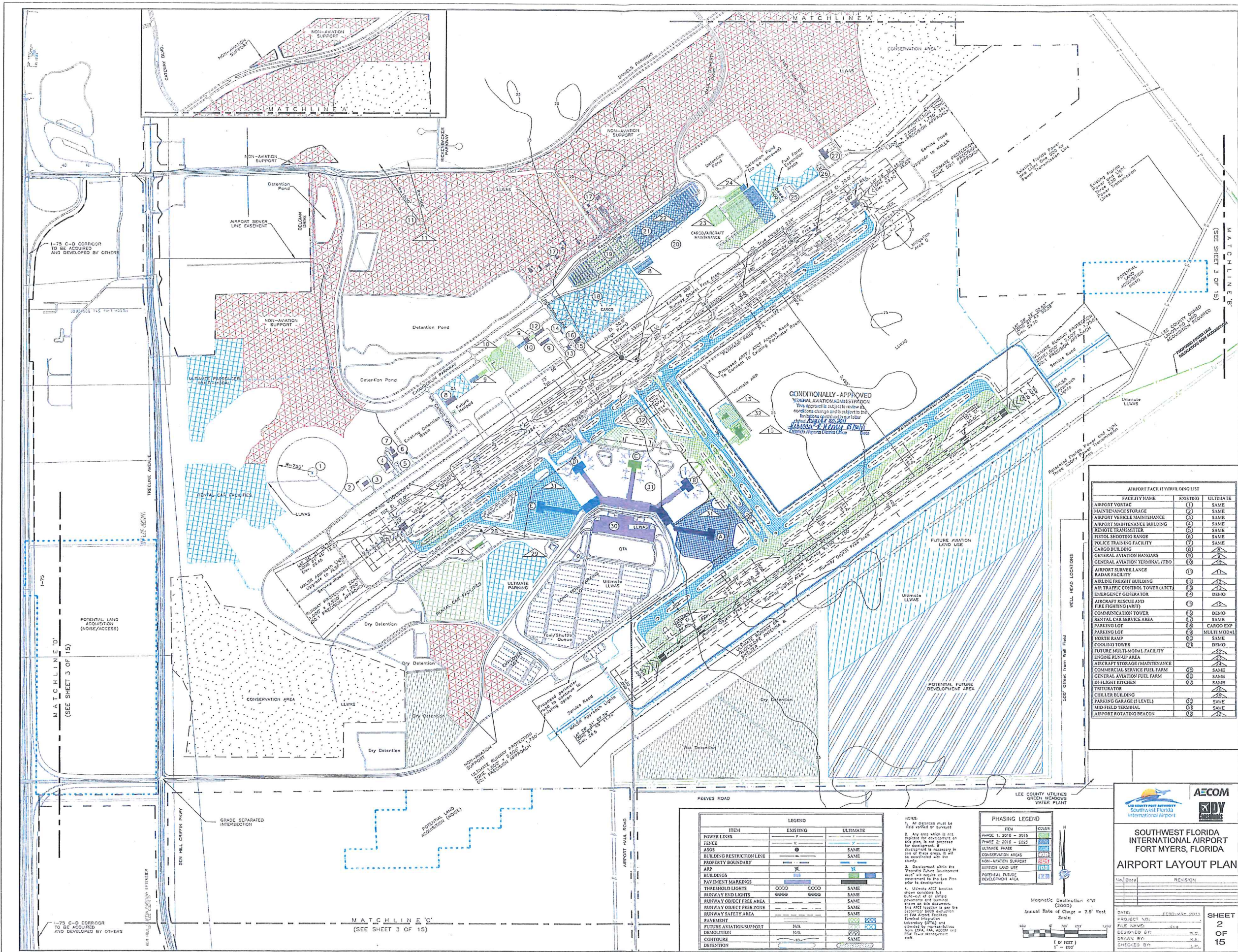

CONDITIONALLY-APPROVED
 FEDERAL AVIATION ADMINISTRATION
 This approval is subject to review and
 modification of the project as required by the
 FAA. The project is subject to the
 FAA's final decision.

AIRPORT FACILITY/BUILDING LIST		
FACILITY NAME	EXISTING	ULTIMATE
AIRPORT VEHICLE MAINTENANCE STORAGE	(1)	SAME
AIRPORT VEHICLE MAINTENANCE	(2)	SAME
AIRPORT MAINTENANCE BUILDING	(3)	SAME
REMOTE TRANSMITTER	(4)	SAME
PISTOL SHOOTING RANGE	(5)	SAME
POLICE TRAINING FACILITY	(6)	SAME
CARGO BUILDING	(7)	SAME
GENERAL AVIATION HANGARS	(8)	SAME
GENERAL AVIATION TERMINAL/FBO	(9)	SAME
AIRPORT SURVEILLANCE RADAR FACILITY	(10)	SAME
AIRLINE FREIGHT BUILDING	(11)	SAME
AIR TRAFFIC CONTROL TOWER (ATCT)	(12)	SAME
EMERGENCY GENERATOR	(13)	DEMO
AIRCRAFT RESCUE AND FIRE FIGHTING (ARFF)	(14)	SAME
COMMUNICATION TOWER	(15)	DEMO
RENTAL CAR SERVICE AREA	(16)	SAME
PARKING LOT	(17)	CARGO EXP
PARKING LOT	(18)	MULTI-MODAL
NORTH RAMP	(19)	SAME
COOLING TOWER	(20)	DEMO
FUTURE MULTI-MODAL FACILITY	(21)	DEMO
ENGINE RUN-UP AREA	(22)	SAME
AIRCRAFT STORAGE/MAINTENANCE	(23)	SAME
COMMERCIAL SERVICE FUEL FARM	(24)	SAME
GENERAL AVIATION FUEL FARM	(25)	SAME
IN-FLIGHT KITCHEN	(26)	SAME
TRITURATOR	(27)	SAME
CHILLER BUILDING	(28)	SAME
PARKING GARAGE (3 LEVEL)	(29)	SAME
MID-FIELD TERMINAL	(30)	SAME
AIRPORT ROTATING BEACON	(31)	SAME

ITEM	EXISTING	ULTIMATE
POWER LINES	---	---
FENCE	---	---
ASPS	---	SAME
BUILDING RESTRICTION LINE	---	SAME
PROPERTY BOUNDARY	---	---
ARS	---	---
BUILDINGS	---	---
PAVEMENT MARKINGS	---	---
THRESHOLD LIGHTS	OOOO	OOOO
RUNWAY END LIGHTS	OOOO	OOOO
RUNWAY OBJECT FREE ZONE	---	SAME
RUNWAY OBJECT FREE ZONE	---	SAME
RUNWAY SAFETY AREA	---	SAME
PAVEMENT	---	---
FUTURE AVIATION SUPPORT	N/A	---
DEMOLITION	---	---
CONTOURS	---	SAME
DETENTION	---	---

NOTES:
 1. All distances must be field verified or surveyed.
 2. Any operation to be developed for development in this area, to be developed for development in one of these areas, it will be coordinated with the county.
 3. Development within the "Potential Future Development Area" will require an approval by the Lee Plan prior to development.
 4. Ultimate ATCT location shown here is a preliminary location. The location of the ATCT will be determined by the FAA in the future.

PHASING LEGEND	
ITEM	COLOR
PHASE 1: 2010 - 2015	Light Blue
PHASE 2: 2015 - 2020	Medium Blue
ULTIMATE PHASE	Dark Blue
CONSERVATION AREAS	Green
NON-AVIATION SUPPORT	Yellow
POTENTIAL LAND USE	Light Green
POTENTIAL FUTURE DEVELOPMENT AREA	Light Blue



AECOM
SIDY

SOUTHWEST FLORIDA INTERNATIONAL AIRPORT
FORT MYERS, FLORIDA

AIRPORT LAYOUT PLAN

DATE: FEBRUARY 2011
 PROJECT NO.:
 DESIGN BY: J.C.
 DRAWN BY: J.C.
 CHECKED BY: J.C.

SHEET 2 OF 15