

**ADMINISTRATIVE AUTHORIZATION (UEE) ADD2001-00102
LEE COUNTY, FLORIDA**

WHEREAS, Rookery Pointe, L.C. has filed an application for administrative authorization of a maximum 2 foot eave encroachment into the 20 foot wide drainage easements for certain lots within Rookery Pointe, which is more particularly described as:

LEGAL DESCRIPTION: In Section 27, Township 46 South, Range 25 East, Lee County, Florida:

Rookery Pointe SUBDIVISION, as recorded in Plat Book, Pages 9-16, of the Public Records of Lee County, Florida, lying in Section 27, Township 46 South, Range 25 East, Lee County, FL.

WHEREAS, the Applicant has indicated the STRAP numbers are as indicated in Exhibit A; and

WHEREAS, the Applicant has indicated the property's Development Order numbers are DOS2000-00162 and DOS2000-00181; and

WHEREAS, the Applicant has indicated the lots to be affected by this amendment are identified in Exhibit A attached hereto; and

WHEREAS, the Lee County Land Development Code Section 10-328(a) (Ordinance 92-44) provides for the Director of Development Services Division authorization to allow a lesser dimension for a drainage easement; and

WHEREAS, the Applicant is in receipt of a letter of approval from the person(s) or entity(s) that holds the subject easement, i.e., the Homeowners Owners Association, which maintains the drainage system and has provided a copy of same to the County; and

WHEREAS, the subject application and plans have been reviewed by the Lee County Development Services Division in accordance with applicable regulations for compliance with all terms of the administrative authorization; and

WHEREAS, the following findings of fact are offered:

- A. The lesser dimension will be in harmony with the general appearance and character of the community.
- B. The lesser dimension will not be injurious to the area involved or otherwise detrimental to the public health, safety or welfare.

NOW, THEREFORE, IT IS HEREBY DETERMINED that under the authority as provided to the Director of Development Services Division in the Lee County Land

Development Code Section 10-328(a) (Ordinance 92-44), the lesser dimension of the subject drainage easement is **APPROVED, limited to the following:**

- a) **The encroachments, not to exceed two feet, are limited to the eaves of the principal structures (homes) only; and**
- b) **The encroachments are limited to only those lots identified by STRAP number in Exhibits A and B;**

DULY SIGNED this 12th day of October, A.D., 2001.

By: 
Peter J. Eckenrode, Director
Development Services Division

Exhibit A: List of STRAP numbers

Exhibit B: Site Plan, stamped Received August 01, 2001

STRAP Numbers- Rookery Pointe Administrative Amendment

27-46-25-10-00004.0160
27-46-25-10-00004.0170
27-46-25-10-00004.0220
27-46-25-10-00004.0230
27-46-25-10-00004.0280
27-46-25-10-00004.0290
27-46-25-10-00004.0340
27-46-25-10-00004.0350
27-46-25-10-00005.0390
27-46-25-10-00005.0400
27-46-25-10-00006.0260
27-46-25-10-00006.0270
27-46-25-10-00007.0020
27-46-25-10-00007.0030
27-46-25-10-00009.0870
27-46-25-10-00009.0880
27-46-25-10-00009.0940
27-46-25-10-00009.0950
27-46-25-10-00009.1090
27-46-25-10-00009.1100
27-46-25-10-00009.1130
27-46-25-10-00009.1140
27-46-25-10-00009.1280
27-46-25-10-00009.1290
27-46-25-10-00010.0300
27-46-25-10-00010.0310
27-46-25-10-00010.0360
27-46-25-10-00010.0370
27-46-25-10-00010.0450
27-46-25-10-00010.0460
27-46-25-10-00010.0300
27-46-25-10-00011.0640
27-46-25-10-00011.0650
27-46-25-10-00011.0690
27-46-25-10-00011.0700
27-46-25-10-00011.0760
27-46-25-10-00011.0770

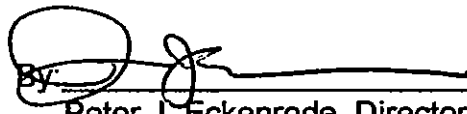
RECEIVED

AUG 01 2001

COMMUNITY DEVELOPMENT

RECEIVED

AUG 01 2001

COMMUNITY DEVELOPMENT

ADD 2001-00102

Exhibit B



Henry D. Hanch
7/20/01

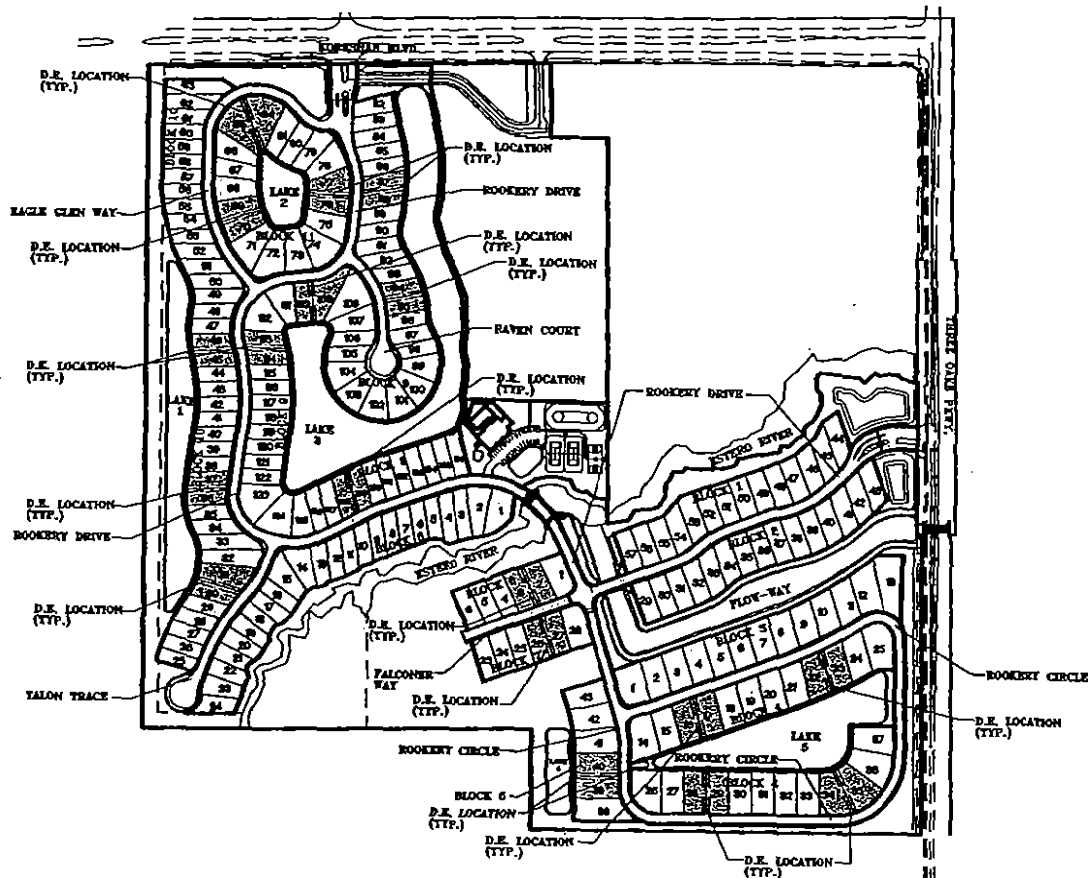

PLAN LOCATIONS

NOTE: HOUSE OVERHANG MAY ENCRUSCH 2' MAXIMUM DISTANCE INTO DRAINAGE EASEMENT (SEE DETAIL).

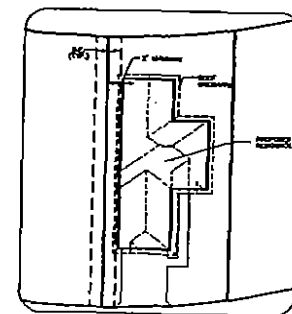

DETAIL LOT SITE (TYP.)

date 7-01
drawn CB
file name: DE_LOC
job: ROOKERY



COMMUNITY ENGINEERING SERVICES, INC.
Civil Engineering • Surveying • Project Management
EB-0006613
9200 Bonita Beach Road Suite 213
Bonita Springs, Florida 34135
Telephone (813) 495-0009 Fax (813) 495-7934

SITE PLAN
OF
ROOKERY POINTE
FOR
KEYSTONE CUSTOM HOMES
24860 BURNT PINE DRIVE
BONITA SPRINGS, FL 34132
(813) 498-4560

scale: 1"=400'

SHEET

1 of 1

date